

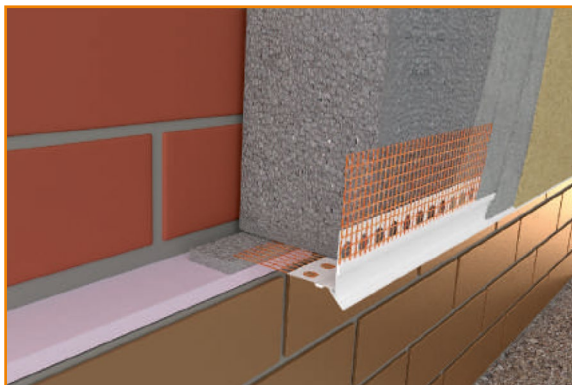

CATALOGUE OF ANCILLARY MATERIALS

FEBRUARY EDITION 2025

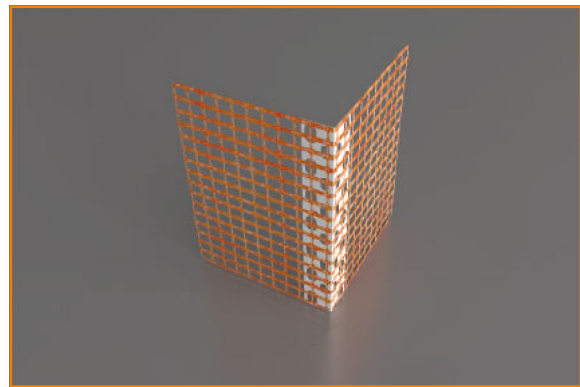
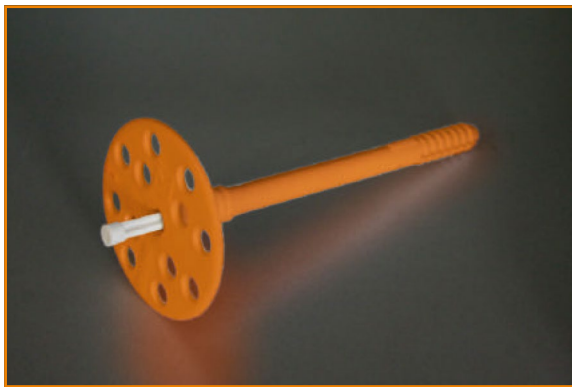

- THERMAL INSULATION MATERIALS
- MECHANICAL FIXING
- REINFORCING MESH
- BEADS, PROFILES & TRIMS
- TOOLS
- OTHERS
- MARKETING MATERIALS

GENERAL DELIVERY CONDITIONS SOLTHERM CATALOGUE

I. ORDERING AND ORDER PROCESSING

1. Bolix S.A. sells goods, whose basic range is listed in the current CATALOGUE, based on orders placed by the Ordering Party.
2. Customer Service Department is at our customers' disposal on working days from 8 a.m. to 4 p.m. You can also place orders by fax 24 hours a day, if you find it more convenient. Fax: +48 33 475 06 23; +48 33 475 06 50 or by e-mail sent to the person responsible for the region.
3. To place orders by fax, we recommend to use the order form provided by Bolix S.A. The order should be made in written form and contain the following:
 - name and quantity of goods with the unit of measurement
 - information on an additional/investment discount, if any (reference number of the discount)
 - place of delivery with postcode
 - delivery method
 - Ordering Party's name and address

Moreover, the order should have the company stamp and signature of the person authorised to place orders. If a delivery address differs from the Ordering Party's address, put name and surname, identity document number and contact number of the person authorised to accept the order.

4. The seller shall not be held responsible for mistakes made in the order by the Ordering Party.
5. In the event the Ordering Party is in arrears with payments or its credit limit has been exceeded, the Bolix Company may refuse to accept and process further orders. Lead time shall be specified for each order individually by a Customer Service Employee. The customer and supervisor in Bolix shall be informed by phone about the specified lead time.
6. BOLIX S.A. reserves the right to change prices in the Catalogue without any advance notice.
7. The Ordering Party may not introduce changes in the order or cancel it unless prior arrangements are made with a Customer Service Employee and confirmed in writing.
8. BOLIX S.A. shall confirm prices and lead time on the next working day the latest.

II. TERMS AND CONDITIONS OF DELIVERY

1. All products are supplied in packaging suitable for the product sold and in conformity with the offer specified in the current CATALOGUE.
2. All Bolix products specified in the current CATALOGUE shall be delivered under the address provided by the Ordering Party within 4 to 14 working days depending on the products ordered and delivery method. Lead time for other products, which are not included in the Bolix offer, shall be specified individually for the Ordering Party.
3. BOLIX S.A. reserves the right to extend lead time if an order for some products does not meet the required production minimum.
4. Delivery at the place named by the Ordering Party in the order may be made on the following conditions:
5. Delivery by a carrier arranged by the Seller to the Ordering Party's outlets.
6. Delivery to a carrier arranged by the Ordering Party within the „Ex Works” shipping terms.
7. Distribution limitations:
 - The goods ordered shall be added to other orders for SOLTHERM or BOLIX products made by the customer, if any.
 - Otherwise the customer shall be charged with shipping costs. The cost shall be established with the customer prior to shipping.
8. In the event goods have been delivered at the wrong address due to wrong address provided by the Ordering Party, the Seller has the right to charge the Ordering Party with all additional shipping costs incurred due to the mistake.
9. BOLIX S.A. shall notify the Ordering Party of back orders, if any.
10. Please note that products delivered may vary slightly in terms of colour and composition from those pictured in the CATALOGUE.

III. COMPLAINTS

Complaints and damages in transport:

- Complaints concerning missing goods and damages in transport shall be made in writing upon acceptance of delivery and with the purchasing documentation enclosed. Each time the complaint shall contain a description of the discrepancies between the goods delivered and the Stock Issue Confirmation (CI) and consignment note, and shall be confirmed by the driver's signature.
- Bolix S.A. shall process quantity complaints within the shortest possible time frame. If the complaint is accepted, the missing products shall be delivered and damaged goods replaced within the shortest possible time frame.
- Bolix S.A. accepts no responsibility for shortages and losses resulting from incorrect transportation within the Ex Works arrangement and incorrect storage.



THERMAL INSULATION MATERIALS



EPS BOARDS 70-031 GRAPHITE*

Thermal conductivity coefficient [W/mk]	Bulk density kg/m ³
$\lambda \leq 0,031$	15

Technical parameters - subject to delivery

THICKNESS [MM]	PCS PER PACKAGE	AMOUNT [M ²] PER PACKAGE	PACKAGE VOLUME [M ³]
10	60	30	0.3
20	30	15	0.3
30	20	10	0.3
40	15	7.5	0.3
50	12	6	0.3
60	10	5	0.3
70	8	4	0.28
80	7	3.5	0.28
90	6	3	0.27
100	6	3	0.3
120	5	2.5	0.3
140	4	2	0.28
150	4	2	0.3
160	4	2	0.32
180	3	1.5	0.27
200	3	1.5	0.3
250	2	1	0.3

EPS BOARDS 70-040 WHITE*

Thermal conductivity coefficient [W/mk]	Bulk density kg/m ³
$\lambda \leq 0,040$	15

Technical parameters - subject to delivery

THICKNESS [MM]	PCS PER PACKAGE	AMOUNT [M ²] PER PACKAGE	PACKAGE VOLUME [M ³]
10	60	30	0.3
20	30	15	0.3
30	20	10	0.3
40	15	7.5	0.3
50	12	6	0.3
60	10	5	0.3
70	8	4	0.28
80	7	3.5	0.28
90	6	3	0.27
100	6	3	0.3
120	5	2.5	0.3
140	4	2	0.28
150	4	2	0.3
160	4	2	0.32
180	3	1.5	0.27
200	3	1.5	0.3
250	2	1	0.3

*The possibility of purchasing mineral wool / eps must be confirmed by customer service department
The boards from 50mm to 200mm may be produced with milled edges



FIXINGS



KOELNER / RAWLPLUG: KI-10

UNIVERSAL HAMMER - IN WALL FIXING



TECHNICAL DATA

HOLE DIAMETER
WASHER DIAMETER
EUROPEAN TECHNICAL APPROVAL
PLUG MATERIAL
PIN TYPE AND MATERIAL

KI-10

10 mm
60 mm
ETA-07/0291
PP
NAIL MADE OF PP REINFORCED WITH GLASS FIBRE ENABLING
EXPANSION OF THE PLUG

FIXING DIMENSIONS		
CODE	DIAMETER x LENGHT (MM)	PCS PER PACKAGE
KI-090	10x90	250
KI-120	10x120	250
KI-140	10x140	250
KI-160	10x160	250
KI-180	10x180	250
KI-200	10x200	250
KI-220	10x220	250

INSULANT	KI-10
EPS	•
XPS	•
MINERAL WOOL	
LAMELLA	

SUBSTRATE	KI-10
A	•
B	•
C	•
D	•
E	•

KOELNER / RAWLPLUG: R-TFIX-8M

HAMMER-IN FACADE FIXING

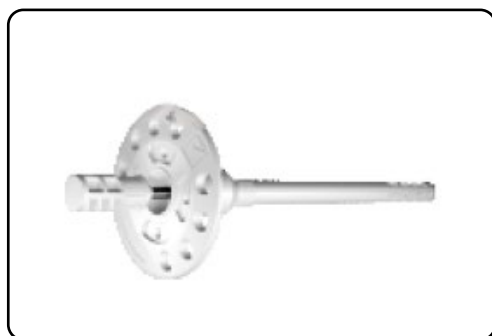

TECHNICAL DATA

HOLE DIAMETER
WASHER DIAMETER
EUROPEAN TECHNICAL APPROVAL
PLUG MATERIAL
PIN TYPE AND MATERIAL

R-TFIX-8

8 mm
60 mm
ETA-07/0336
PP
1 GALVANIZED CARBON STEEL
WITH NYLON COATED HEAD

FIXING DIMENSIONS		
CODE	DIAMETER x LENGHT (MM)	PCS PER PACKAGE
R-TFIX-8M-095	8x95	200
R-TFIX-8M-115	8x115	200
R-TFIX-8M-135	8x135	200
R-TFIX-8M-155	8x155	200
R-TFIX-8M-175	8x175	200
R-TFIX-8M-195	8x195	200
R-TFIX-8M-215	8x215	100
R-TFIX-8M-235	8x235	100
R-TFIX-8M-255	8x255	100
R-TFIX-8M-275	8x275	100
R-TFIX-8M-295	8x295	100

INSULANT	TFIX-8M
EPS BOARDS	•
XPS BOARDS	•
MINERAL WOOL	•
LAMELLA	•

SUBSTRATE	TFIX-8M
A	•
B	•
C	•
D	
E	

KOELNER / RAWLPLUG: R-TFIX-8S

UNIVERSAL SCREW-IN WALL FIXING



TECHNICAL DATA

HOLE DIAMETER
WASHER DIAMETER
EUROPEAN TECHNICAL APPROVAL
PLUG MATERIAL
PIN TYPE AND MATERIAL

R-TFIX-8S

8 mm
60 mm
ETA-11/1044
PP
GALVANIZED CARBON STEEL WITH PA
HEAD REINFORCED WITH GLASS FIBRE

FIXING DIMENSIONS		
CODE	DIAMETER x LENGTH (MM)	PCS PER PACKAGE
R-TFIX-8S-115	8x115	100
R-TFIX-8S-135	8x135	100
R-TFIX-8S-155	8x155	100
R-TFIX-8S-175	8x175	100
R-TFIX-8S-195	8x195	100
R-TFIX-8S-215	8x215	100
R-TFIX-8S-235	8x235	100
R-TFIX-8S-255	8x255	100
R-TFIX-8S-275	8x275	100
R-TFIX-8S-295	8x295	100

FIXING DIMENSIONS		
CODE	DIAMETER x LENGTH (MM)	PCS PER PACKAGE
R-TFIX-8S-335	8x335	100
R-TFIX-8S-355	8x335	100
R-TFIX-8S-375	8x375	100
R-TFIX-8S-395	8x395	100
R-TFIX-8S-415	8x415	50
R-TFIX-8S-435	8x435	50
R-TFIX-8S-455	8x455	50

INSULANT	TFIX-8S
EPS BOARDS	•
XPS BOARDS	•
MINERAL WOOL	•
LAMELLA	•

SUBSTRATE	TFIX-8S
A	•
B	•
C	•
D	•
E	•

RAWLPLUG MBA-SS



TECHNICAL DATA

WASHER DIAMETER
FIXING TYPE
PLUG DIAMETER
WASHER MATERIAL
EUROPEAN TECHNICAL APPROVAL
PRODUCT CODE
PCS PER PACKAGE

MBA-SS

90 mm
ŁTX, ŁFM
8mm or 10mm
PE
ETA-11/0281
TDX-90
200

USE:

Stainless steel facade dowel.

FIXING		
CODE	DIAMETER x LENGTH (MM)	PCS PER PACKAGE
MBA-SS-08090	8x90	250
MBA-SS-08110	8x110	250
MBA-SS-08140	8x140	250
MBA-SS-08170	8x170	250
MBA-SS-08200	8x200	250
MBA-SS-08250	8x250	125
MBA-SS-08300	8x300	125
MKC-SS-85	Ø80	250

SUBSTRATE	MBA-SS
DEPENDS ON THE FIXING	

INSULANT	MBA-SS
EPS	•
XPS	•
MINERAL WOOL	•
LAMELLA	•

RAWLPLUG ISO-PLUG

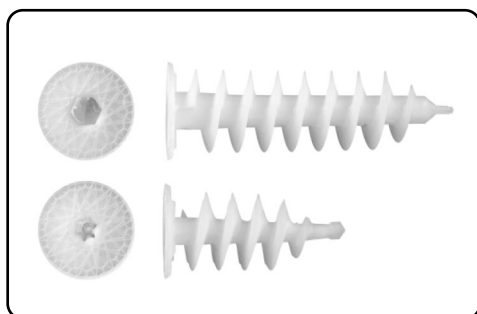

USE:

Spiral anchor to fix lightweight add-on parts to ETICS

TECHNICAL DATA

CUTTER DIAMETER

FIXING TYPE

PRODUCT CODE

ISO-PLUG

28 mm

ISO-PLUG-80

R-ISO-PLUG

SUBSTRATE	ISO-PLUG
DEPENDS ON THE FIXING	

INSULANT	ISO-PLUG
EPS	•
XPS	•
MINERAL WOOL	•
LAMELLA	•

FIXING				
CODE	FIXING LENGTH	WASHER DIAMETER [MM]	SCREW DIAMETER [MM]	PCS PER PACKAGE
ISO-PLUG 50	50	28	4/5	50
ISO-PLUG 80	80	28	6/7	40

RAWLPLUG KCX + WX

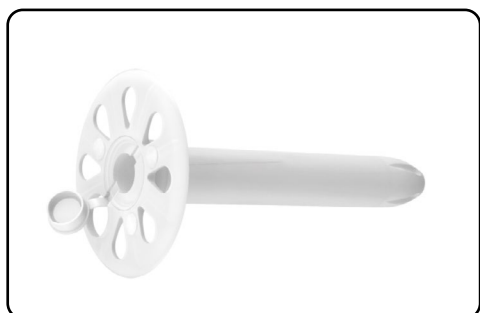

USE:

Pressure plate with a plug for attaching thermal insulation to wood and steel sheet.

TECHNICAL DATA

CUTTER DIAMETER

FIXING TYPE

PRODUCT CODE

KCX

60

KCX+WX

KCX

SUBSTRATE	KCX
DEPENDS ON THE FIXING	

INSULANT	KCX
EPS	•
XPS	•
MINERAL WOOL	
LAMELLA	

FIXING		
CODE	DIAMETER x LENGTH (MM)	PCS PER PACKAGE
KCX-055	6X55	400
KCX-105	6X105	250
KCX-165	6X165	150

FIXING		
CODE	DIAMETER x LENGTH (MM)	PCS PER PACKAGE
WX-48050	4,8X50	250
WX-48060	4,8X60	250
WX-48070	4,8X70	250
WX-48080	4,8X80	250
WX-48100	4,8X100	200
WX-48120	4,8X120	200
WX-48140	4,8X140	200
WX-48160	4,8X160	100
WX-48180	4,8X180	100

RAWLPLUG EPS CAP Ø63MM

EPS FOAM CAP



USE:

Installation of thermal insulation fixings with foam caps:

- facilitates and quickens surface preparation prior to finish coat applications
- enables the use of 20mm shorter fixings when compared to fixing installation without foam cap
- eliminates thermal bridges

TECHNICAL DATA

CUTTER DIAMETER
FIXING TYPE
PRODUCT CODE
PCS PER PACKAGE

RAWLPLUG EPS CAP STR WHITE

63 mm
EPS-W
R-TFIX-CAP63-EPS-W
100

RAWLPLUG EPS CAP GREY

63 mm
EPS-G
R-TFIX-CAP63-EPS-G
100

INSULANT	RAWLPLUG EPS CAP
EPS	•
XPS	•
MINERAL WOOL	
LAMELLA	

SUBSTRATE	RAWLPLUG EPS CAP
DEPENDS ON THE FIXING	

RAWLPLUG MW CAP Ø63MM

CAP OF MINERAL WOOL OR MW LAMELLA



USE:

Installation of thermal insulation fixings with mineral wool caps:

- facilitates and quickens surface preparation prior to finish coat applications
- enables the use of 20mm shorter fixings when compared to fixing installation

TECHNICAL DATA

CUTTER DIAMETER
FIXING TYPE
PRODUCT CODE
PCS PER PACKAGE

RAWLPLUG MW CAP

63 mm
MW
R-TFIX-CAP63-MW
100

INSULANT	RAWLPLUG MW CAP
EPS	
XPS	
MINERAL WOOL	•
LAMELLA	•

SUBSTRATE	RAWLPLUG MW CAP
DEPENDS ON THE FIXING	

KOELNER / RAWLPLUG: KWL-140

SUPPORT WASHER FOR FIXING MINERAL WOOL AND MW LAMELLA



USE:

Use support washers with fixings to fix mineral wool lamella with horizontally-oriented fibres. Large clamping area of the washer provides pull through resistance. Support washers perfectly complete any type of mineral wool fixings.

TECHNICAL DATA

WASHER DIAMETER
FIXING TYPE
PLUG DIAMETER
WASHER MATERIAL
EUROPEAN TECHNICAL APPROVAL
PRODUCT CODE
PCS PER PACKAGE

KWL-140

140 mm
TFIX, KI
8 mm or 10 mm
PP
ETA-07/0291
KWL-140-PP
200
nylon (PA)
07/0221
KWL-140
200

INSULANT	KWL-140
EPS	
XPS	
MINERAL WOOL	•
LAMELLA	•

SUBSTRATE	KWL-140
DEPENDS ON THE FIXING	

KOELNER / RAWLPLUG: KWL-90

SUPPORT WASHER FOR FIXING MINERAL WOOL AND MW LAMELLA

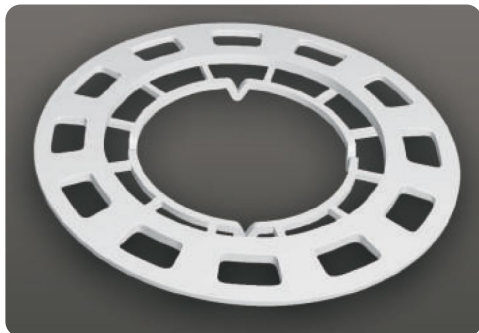

TECHNICAL DATA

WASHER DIAMETER
FIXING TYPE
PLUG DIAMETER
WASHER MATERIAL
EUROPEAN TECHNICAL APPROVAL
PRODUCT CODE
PCS PER PACKAGE

KWL-90

90 mm
TFIX, KI
8 mm or 10 mm
PP
ETA-07/0291
KWL-090-PP
200
nylon (PA)
07/0221
KWL-090
200

USE:

Use support washers with fixings to fix mineral wool lamella with horizontally-oriented fibres. Large clamping area of the washer provides pull through resistance. Support washers perfectly complete any type of mineral wool fixings.

INSULANT	KWL-90
EPS	
XPS	
MINERAL WOOL	.
LAMELLA	.

SUBSTRATE	KWL-90
DEPENDS ON THE FIXING	

EJOT: EJOTHERM STR U 2G

UNIVERSAL SCREW-IN ANCHOR FOR COUNTERSUNK AND SURFACE FIXED INSTALLATION



TECHNICAL DATA

HOLE DIAMETER
WASHER DIAMETER
EUROPEAN TECHNICAL APPROVAL
PLUG MATERIAL
PIN TYPE AND MATERIAL

EJOTHERM STR U 2G

8 mm
60 mm
ETA-04/0023
PE
STAINLESS OR GALVANIZED STEEL SCREW,
PRE-MOUNTED FOR QUICK INSTALLATION
(DOUBLE THREAD)

FIXING DIMENSIONS		
CODE	DIAMETER x LENGTH (MM)	PCS PER PACKAGE
ejotherm STR U 2G 115	8x115	100
ejotherm STR U 2G 135	8x135	100
ejotherm STR U 2G 155	8x155	100
ejotherm STR U 2G 175	8x175	100
ejotherm STR U 2G 195	8x195	100
ejotherm STR U 2G 215	8x215	100
ejotherm STR U 2G 235	8x235	100
ejotherm STR U 2G 255	8x255	100
ejotherm STR U 2G 275	8x275	100
ejotherm STR U 2G 295	8x295	100

FIXING DIMENSIONS		
CODE	DIAMETER x LENGTH (MM)	PCS PER PACKAGE
ejotherm STR U 2G 315	8x315	100
ejotherm STR U 2G 335	8x335	100
ejotherm STR U 2G 355	8x355	100
ejotherm STR U 2G 375	8x375	100
ejotherm STR U 2G 395	8x395	100
ejotherm STR U 2G 415	8x415	100
ejotherm STR U 2G 435	8x435	100
ejotherm STR U 2G 455	8x455	100

INSULANT	STR U 2G
EPS	.
XPS	.
MINERAL WOOL	.
LAMELLA	.

SUBSTRATE	STR U 2G
A	.
B	.
C	.
D	.
E	.

EJOT STR H

HAMMER-IN SCREW-IN FIXING WITH METAL PIN

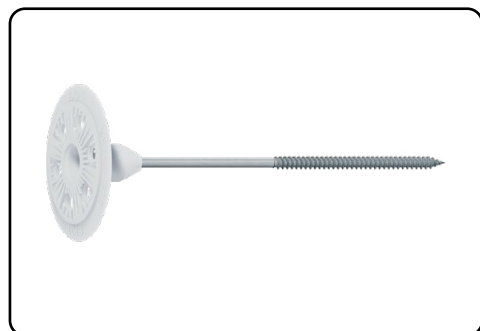

TECHNICAL DATA

WASHER DIAMETER
FIXING TYPE
PRODUCT CODE

EJOT STR H

60 mm
EJOT
EJOT STR H

USE:

Insulation fastener for wood fibre insulation materials.

FIXING		
CODE	DIAMETER x LENGHT (MM)	PCS PER PACKAGE
EJOT STR H 080	6x80	100
EJOT STR H 100	6x100	100
EJOT STR H 120	6x120	100
EJOT STR H 140	6x140	100
EJOT STR H 160	6x160	100
EJOT STR H 180	6x180	100

FIXING		
CODE	DIAMETER x LENGHT (MM)	PCS PER PACKAGE
EJOT STR H 200	6x200	100
EJOT STR H 240	6x240	100
EJOT STR H 260	6x260	100
EJOT STR H 280	6x280	100
EJOT STR H 300	6x300	100

INSULANT	EJOT STR H
EPS	
XPS	
MINERAL WOOL	•
LAMELLA	•

SUBSTRATE	EJOT STR H
DEPENDS ON THE FIXING	

EJOT: EJOT H4

UNIVERSAL HAMMER-IN FIXING



TECHNICAL DATA

FIXING TYPE
WASHER MATERIAL
EUROPEAN TECHNICAL APPROVAL
PLUG MATERIAL
PIN TYPE AND MATERIAL

EJOT H4 ECO

8 mm
60 mm
ETA-11/0192
PE
GALVANIZED CARBON STEEL
WITH PA HEAD

FIXING DIMENSIONS		
CODE	DIAMETER x LENGHT (MM)	PCS PER PACKAGE
EJOT H4 ECO 155	8x155	100
EJOT H4 ECO 175	8x175	100
EJOT H4 ECO 195	8x195	100
EJOT H4 ECO 215	8x215	100
EJOT H4 ECO 235	8x235	100
EJOT H4 ECO 255	8x255	100
EJOT H4 ECO 275	8x275	100
EJOT H4 ECO 295	8x295	100

INSULANT	EJOT H4
EPS	•
XPS	•
MINERAL WOOL	•
LAMELLA	•

SUBSTRATE	EJOT H4
A	•
B	•
C	•
D	•
E	•

EJOT ISO-SPIRALE

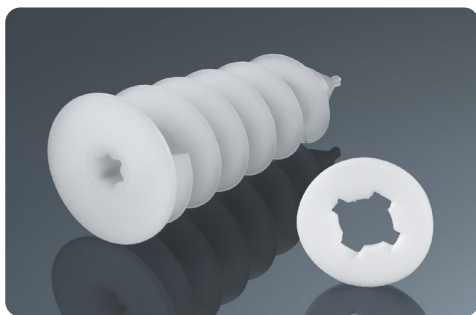

TECHNICAL DATA

CUTTER DIAMETER
FIXING TYPE
PRODUCT CODE

ISO-SPIRALE

35 mm
EJOT Spiral anchor
ISO-SPIRALE

USE:

Spiral anchor to fix lightweight add-on parts to ETICS

FIXING				
CODE	FIXING LENGHT	WASHER DIAMETER [MM]	SCREW DIAMETER [MM]	PCS PER PACKAGE
ISO-SPIRALE	59	25	4/5	100

INSULANT	ISO-SPIRALE
EPS	•
XPS	•
MINERAL WOOL	•
LAMELLA	•

SUBSTRATE	ISO-SPIRALE
DEPENDS ON THE FIXING	

EJOT: EJOTHERM STR-TOOL 2G Ø65MM

SPECIALLY DEVELOPED TOOL FOR COUNTERSUNK INSTALLATION OF EJOTHERM STR U 2G



TECHNICAL DATA

CUTTER DIAMETER
FIXING TYPE
PRODUCT CODE
PCS PER PACKAGE
PRICE [EUR]

EJOTHERM STR TOOL 2G

65 mm
ejotherm STR
ejotherm STR-tool 2G
1
-

FIXING DIMENSIONS	
CODE	NO. OF UNITS PACKAGE
EJOTHERM®STR-TOOL 2G S	1
EJOTHERM SP® ARE PARTS STR	1
EJOTHER SDS-PLUS ADAPTER STR-TOOL 2G S	1
EJOTHERM SW 10x160 HEXAGON ADAPTER TO STR-TOOL 2G S	1

INSULANT	EJOT STR-TOOL 2G
EPS	•
XPS	•
MINERAL WOOL	•
LAMELLA	•

SUBSTRATE	EJOT STR-TOOL 2G
DEPENDS ON THE FIXING	

USE:

Tool for cutting into foam prior to foam or mineral wool cap installation
- specially developed tool for countersunk installation of ejotherm STR U 2G
- suitable for both ejotherm STR U and ejotherm STR H
- adjustable for all anchor length

- easy scaling for adjustment to the required anchor length
- for reliable and easy installation according to the EJOT STR principle
- robust design for long service life
- quickly replaceable wear parts
- kit consists of: ejotherm STR-tool 2G, additional cutting sheets, offset screw driver as well as bits for all applications

EJOT: VT-90

SUPPORT WASHER FOR FIXING MINERAL WOOL AND MW LAMELLA



TECHNICAL DATA

WASHER DIAMETER
FIXING TYPE
PLUG DIAMETER
WASHER MATERIAL
EUROPEAN TECHNICAL APPROVAL
PRODUCT CODE
PCS PER PACKAGE

EJOT VT-90

90 mm
STR U, NTK U
8 mm or 10 mm
PE
ETA-07/0026
EJOT VT-90
100

USE:

Use support washers with fixings to fix mineral wool lamella with horizontally-oriented fibres. Large clamping area of the washer provides pull through resistance. Support washers perfectly complete any type of mineral wool fixings.

INSULANT	EJOT VT-90
EPS	
XPS	
MINERAL WOOL	•
LAMELLA	•

SUBSTRATE	EJOT VT-90
DEPENDS ON THE FIXING	

EJOT: SBL 140 PLUS

SUPPORT WASHER FOR FIXING MINERAL WOOL AND MW LAMELLA



TECHNICAL DATA

WASHER DIAMETER
FIXING TYPE
PLUG DIAMETER
WASHER MATERIAL
EUROPEAN TECHNICAL APPROVAL
PRODUCT CODE
PCS PER PACKAGE

EJOT SBL 140 PLUS

140 mm
STR U, NTK U
8 mm or 10 mm
PE
ETA-07/0026
EJOT SBL 140 PLUS
100

USE:

Use support washers with fixings to fix mineral wool lamella with horizontally-oriented fibres. Large clamping area of the washer provides pull through resistance. Support washers perfectly complete any type of mineral wool fixings.

INSULANT	SBL 140 PLUS
EPS	
XPS	
MINERAL WOOL	•
LAMELLA	•

SUBSTRATE	SBL 140 PLUS
DEPENDS ON THE FIXING	

EJOT: EJOTHERM STR Ø65MM

EPS FOAM CAP WHITE AND GRAPHITE



TECHNICAL DATA

CUTTER DIAMETER
FIXING TYPE
PRODUCT CODE
PCS PER PACKAGE

EJOTHERM STR WHITE

65 mm
EJOT do EPS
ejotherm®cap STR EPS - white* - white*
100

EJOTHERM STR GREY

65 mm
EJOT do EPS
ejotherm®cap STR EPS - graphite*
100

USE:

Installation of thermal insulation fixings with foam caps:

- facilitates and quickens surface preparation prior to finish coat applications
- enables the use of 20mm shorter fixings when compared to fixing installation without foam cap
- eliminates thermal bridges

INSULANT	EJOTHERM STR
EPS	•
XPS	•
MINERAL WOOL	
LAMELLA	

SUBSTRATE	EJOTHERM STR
DEPENDS ON THE FIXING	

EJOT: EJOTHERM STR Ø65MM

CAP OF MINERAL WOOL OR MW LAMELLA



TECHNICAL DATA

CUTTER DIAMETER
FIXING TYPE
PRODUCT CODE
PCS PER PACKAGE

EJOTHERM STR MW

65 mm
EJOT do MW
ejotherm® cap STR MIWO*
100

USE:

Installation of thermal insulation fixings with mineral wool caps:

- facilitates and quickens surface preparation prior to finish coat applications
- enables the use of 20mm shorter fixings when compared to fixing installation without foam cap

INSULANT	EJOTHERM STR MW
EPS	
XPS	
MINERAL WOOL	•
LAMELLA	•

SUBSTRATE	EJOTHERM STR MW
DEPENDS ON THE FIXING	

KLIMAS WKREŹ-MET: LFMG

HAMMER-IN SCREW-IN FIXING WITH METAL PIN AND EXTENDED EXPANSION ZONE



TECHNICAL DATA

HOLE DIAMETER
WASHER DIAMETER
EUROPEAN TECHNICAL APPROVAL
PLUG MATERIAL
PIN TYPE AND MATERIAL

LMFG

10 mm
60 mm
ETA-06/0105
POLYPROPYLENE
1 GALVANIZED CARBON STEEL WITH NYLON COATED HEAD

FIXING		
CODE	DIAMETER x LENGHT (MM)	PCS PER PACKAGE
LFMG08100(200)	8x100	200
LFMG08120(200)	8x120	200
LFMG08140(200)	8x140	200
LFMG08160(200)	8x160	200
LFMG08180(200)	8x180	200
LFMG08200(200)	8x200	200
LFMG10140(200)	10x140	200
LFMG10160(200)	10x160	200
LFMG10180(200)	10x180	200
LFMG10200(200)	10x200	200
LFMG10220(200)	10x220	100
LFMG10260(200)	10x260	100
LFMG10300(200)	10x300	100

INSULANT	LTXØ8	LTXØ10
EPS	•	•
XPS	•	•
MINERAL WOOL	•	•
LAMELLA	•	•

SUBSTRATE	LTXØ8	LTXØ10
A	•	•
B	•	•
C	•	•
D	•	•
E	•	•
F	•	•

KLIMAS WKREŹ-MET: LTX

UNIVERSAL HAMMER-IN FIXING WITH PLASTIC PIN



TECHNICAL DATA

HOLE DIAMETER
WASHER DIAMETER
EUROPEAN TECHNICAL APPROVAL
PLUG MATERIAL
PIN TYPE AND MATERIAL

LTXØ8

LTXØ10

8 mm
60 mm
ETA-09/0001
POLYPROPYLENE
GLASS FIBRE REINFORCED POLYAMIDE

FIXING		
CODE	DIAMETER x LENGHT (MM)	PCS PER PACKAGE
LTX08095(200)	8x95	200
LTX08115(200)	8x115	200
LTX08135(200)	8x135	200
LTX08155(200)	8x155	200
LTX08175(200)	8x175	200
LTX08195(200)	8x195	200
LTX10070(200)	10x70	200
LTX10090(200)	10x90	200
LTX10110(200)	10x110	200
LTX10120(200)	10x120	200

FIXING		
CODE	DIAMETER x LENGHT (MM)	PCS PER PACKAGE
LTX10140(200)	10x140	200
LTX10160(200)	10x160	200
LTX10180(200)	10x180	200
LTX10200(200)	10x200	200
LTX10220(100)	10x220	100
LTX10260(100)	10x260	100

INSULANT	LTXØ8	LTXØ10
EPS	•	•
XPS	•	•
MINERAL WOOL		
LAMELLA		

SUBSTRATE	LTXØ8	LTXØ10
A	•	•
B	•	•
C	•	
D	•	•
E	•	•

KLIMAS WKREȚ-MET WKTHERM

UNIVERSAL HAMMER-IN FIXING WITH METAL PIN

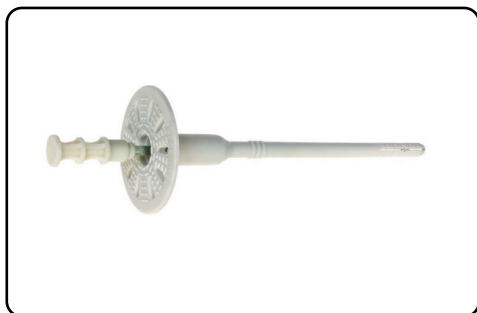

TECHNICAL DATA

WASHER DIAMETER
FIXING TYPE
PRODUCT CODE

WKTHERM

60
wkreȚ-met for EPS
WKTHERM

SUBSTRATE	WK-FT
DEPENDS ON THE FIXING	

INSULANT	WK-FT
EPS	•
XPS	•
MINERAL WOOL	
LAMELLA	

FIXING		
CODE	DIAMETER x LENGTH (MM)	PCS PER PACKAGE
WKTHERM08095(200)	8X95	200
WKTHERM08115(200)	8X115	200
WKTHERM08135(200)	8X135	200
WKTHERM08155(200)	8X155	200
WKTHERM08175(200)	8X175	200

FIXING		
CODE	DIAMETER x LENGTH (MM)	PCS PER PACKAGE
WKTHERM08215(100)	8X215	100
WKTHERM08235(100)	8X235	100
WKTHERM08255(100)	8X255	100
WKTHERM08275(100)	8X275	100

FIXINGS

KLIMAS WKREȚ-MET WKTHERM-S

UNIVERSAL HAMMER-IN FIXING WITH METAL PIN

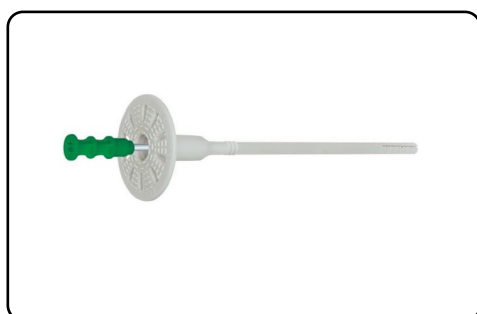

TECHNICAL DATA

WASHER DIAMETER
FIXING TYPE
PRODUCT CODE

WKTHERM-KS

60 mm
wkreȚ-met for EPS
WKTHERM S

SUBSTRATE	WKTHERM-KS
DEPENDS ON THE FIXING	

INSULANT	WKTHERM-KS
EPS	•
XPS	•
MINERAL WOOL	
LAMELLA	

FIXING		
CODE	DIAMETER x LENGTH (MM)	PCS PER PACKAGE
WKTHERM-S-08095(200)	8X95	200
WKTHERM-S-08115(200)	8X115	200
WKTHERM-S-08135(200)	8X135	200
WKTHERM-S-08155(200)	8X155	200
WKTHERM-S-08175(200)	8X175	200
WKTHERM-S-08195(200)	8X195	200

FIXING		
CODE	DIAMETER x LENGTH (MM)	PCS PER PACKAGE
WKTHERM-S-08215(100)	8X215	100
WKTHERM-S-08235(100)	8X235	100
WKTHERM-S-08255(100)	8X255	100
WKTHERM-S-08275(100)	8X275	100
WKTHERM-S-08295(100)	8X295	100

KLIMAS WKREŢ-MET THERMODRIVE-V2



TECHNICAL DATA

WASHER DIAMETER
FIXING TYPE
EUROPEAN TECHNICAL APPROVAL
PRODUCT CODE

THERMODRIVE-V2

60 mm
ŁTX, ŁFM
ETA-11/0281
TDX-90

SUBSTRATE	THERMODRIVE-V2
WKREŢ-MET MLN	

INSULANT	THERMODRIVE-V2
EPS	•
XPS	•
MINERAL WOOL	•
LAMELLA	•

FIXING		
CODE	DIAMETER x LENGHT (MM)	PCS PER PACKAGE
ThermoDrive-V2-08135(200)	8X135	200
ThermoDrive-V2-08155(200)	8X155	200
ThermoDrive-V2-08175(200)	8X175	200
ThermoDrive-V2-08195(200)	8X195	200
ThermoDrive-V2-08215(100)	8X215	100
ThermoDrive-V2-08235(100)	8X235	100
ThermoDrive-V2-08255(100)	8X255	100
ThermoDrive-V2-08275(100)	8X275	100

FIXING		
CODE	DIAMETER x LENGHT (MM)	PCS PER PACKAGE
ThermoDrive-V2-08315(100)	8X315	100
ThermoDrive-V2-08335(100)	8X335	100
ThermoDrive-V2-08355(100)	8X355	100
ThermoDrive-V2-08375(100)	8X375	100
ThermoDrive-V2-08415(100)	8X395	100
ThermoDrive-V2-08435(100)	8X415	100
ThermoDrive-V2-08455(100)	8X435	100

KLIMAS WKREŢ-MET MLN

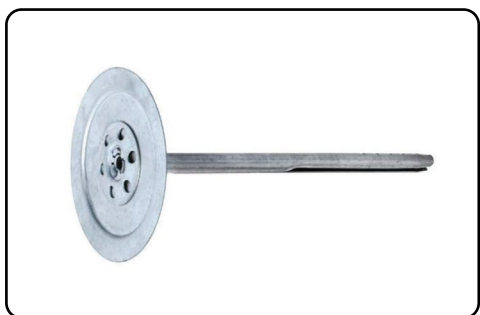

TECHNICAL DATA

WASHER DIAMETER
FIXING TYPE
PRODUCT CODE

MLN

70/85
wkreŢ-met for MW
WKREŢ-MET MLN

USE:

Tool for cutting into foam for foam cap installation.

SUBSTRATE	MLN
DEPENDS ON THE FIXING	

INSULANT	MLN
EPS	•
XPS	•
MINERAL WOOL	
LAMELLA	

FIXING		
CODE	DIAMETER x LENGHT (MM)	PCS PER PACKAGE
MLN08140	8X140	50
MLN08170	8X170	50
MLN08200	8X200	50
MLN08210	8X210	50
MLN08230	8X230	50
MLN08250	8X250	50
MLN08260	8X260	50
MLN08300	8X300	50

KLIMAS WKREŃ-MET: WK-DS

SPIRAL FIXING

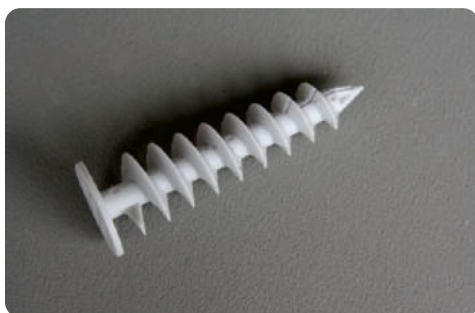

FIXING				
CODE	FIXING LENGTH	WASHER DIAMETER [MM]	SCREW DIAMETER [MM]	PCS PER PACKAGE
WK-DS 50	50	28	4.5	10
WK-DS 85	85	28	4.5	10

USE:

For fixing light attachments (up to 5 kg/fixing) to polystyrene insulation.

INSULANT	WK-DS
EPS	•
XPS	
MINERAL WOOL	
LAMELLA	

KLIMAS WKREŃ-MET: TDX-140

SUPPORT WASHER FOR FIXING MINERAL WOOL AND MW LAMELLA



TECHNICAL DATA

WASHER DIAMETER
FIXING TYPE
PLUG DIAMETER
WASHER MATERIAL
EUROPEAN TECHNICAL APPROVAL
PRODUCT CODE
PCS PER PACKAGE

TDX-140

140 mm
ŁTX, ŁFM
8mm or 10mm
nylon (PA)
ETA-08/0172
TDX-140
200

USE:

Use support washers with fixings to fix mineral wool lamella with horizontally-oriented fibres. Large clamping area of the washer provides pull through resistance. Support washers perfectly complete any type of mineral wool fixings.

SUBSTRATE	TDX-140
DEPENDS ON THE FIXING	

INSULANT	TDX-140
EPS	
XPS	
MINERAL WOOL	•
LAMELLA	•

KLIMAS WKREŃ-MET: TDX-90

SUPPORT WASHER FOR FIXING MINERAL WOOL AND MW LAMELLA



TECHNICAL DATA

WASHER DIAMETER
FIXING TYPE
PLUG DIAMETER
WASHER MATERIAL
EUROPEAN TECHNICAL APPROVAL
PRODUCT CODE
PCS PER PACKAGE

TDX-90

90 mm
ŁTX, ŁFM
8mm or 10mm
PE
ETA-11/0281
TDX-90
200

USE:

Use support washers with fixings to fix mineral wool lamella with horizontally-oriented fibres. Large clamping area of the washer provides pull through resistance. Support washers perfectly complete any type of mineral wool fixings.

SUBSTRATE	TDX-90
DEPENDS ON THE FIXING	

INSULANT	TDX-90
EPS	
XPS	
MINERAL WOOL	•
LAMELLA	•

WKREȚ-MET: WK-FT Ø67MM

DISC CUTTER FOR POLYSTYRENE



USE:

Tool for cutting into foam for foam cap installation.

TECHNICAL DATA

CUTTER DIAMETER
FIXING TYPE
PRODUCT CODE
PCS PER PACKAGE

WK-FT

67
wkreȚ-met for EPS
WK-FT
1

SUBSTRATE	WK-FT
DEPENDS ON THE FIXING	

INSULANT	WK-FT
EPS	•
XPS	•
MINERAL WOOL	
LAMELLA	

WKREȚ-MET: KS Ø67MM

EPS FOAM CAP



USE:

Installation of thermal insulation fixings with foam caps:
- facilitates and quickens surface preparation prior to finish coat applications
- enables the use of 20mm shorter fixings when compared to fixing installation without foam cap

TECHNICAL DATA

CUTTER DIAMETER
FIXING TYPE
PRODUCT CODE
PCS PER PACKAGE

KS

67 mm
wkreȚ-met for EPS
KS
100

SUBSTRATE	KS
DEPENDS ON THE FIXING	

INSULANT	KS
EPS	•
XPS	•
MINERAL WOOL	
LAMELLA	

WKREȚ-MET: EDMW Ø67MM

CAP OF MINERAL WOOL OR MW LAMELLA



USE:

Installation of thermal insulation fixings with foam caps:
- facilitates and quickens surface preparation prior to finish coat applications
- enables the use of 20mm shorter fixings when compared to fixing installation without foam cap

TECHNICAL DATA

CUTTER DIAMETER
FIXING TYPE
PRODUCT CODE
PCS PER PACKAGE

EDMW

67 mm
WKREȚ -MET FOR MW
EDMW
100

SUBSTRATE	EDMW
DEPENDS ON THE FIXING	

INSULANT	EDMW
EPS	•
XPS	•
MINERAL WOOL	•
LAMELLA	

PATTENTED CROSS FIXING SYSTEM

‘Cross-knot’ is a unique EWI solution, which combines full forces of the reinforcement and insulation material. In this solution a special mechanical fixing goes through two crossed fibreglass mesh strips to provide extreme resistance to wind loads. A standard fixing provides reinforcement area restricted to the support washer area, but in Cross Knot System this area has been extended since the crossed strips are both attached to insulation material and fixed to the reinforcement. Moreover, the mechanical fixing used in Cross Knot Fixing, has the capability to mechanically hold down the insulation due to screw-in fixing which can be tightened. It ensures full control over efficient installation of each fixing and eliminates the effects of dynamic action, occurring when the the pin is hammered in, since the hammer may damage the anchoring area, especially when the substrate is weak. This is crucial for retrofit insulation, where it is necessary to obtain optimal stress in the insulation structure (fixing strength basically relies on mechanical fixing). Cross Knot Fixing has been designed to fasten thermal insulation (mineral wool or EPS foam) in solutions requiring enhanced durability and absolute reliability of the mechanical fixing.

It is recommended for fixing the thermal insulation:

- of high thickness
- on gable walls or other with no window openings
- on walls of high buildings
- on high wind suction load areas
- on weak substrates
- when heavy cladding (e.g. stone) is applied to thermal insulation
- when thermal insulation is applied to the existing one (DOUBLE THERM technique)



If applied correctly, Cross Knot Fixing makes the façade practically fully resistant to damaging wind forces.

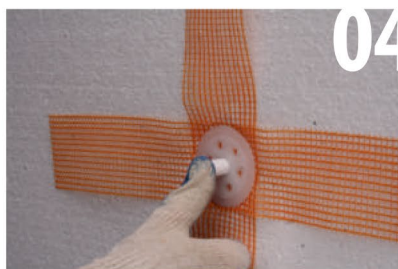
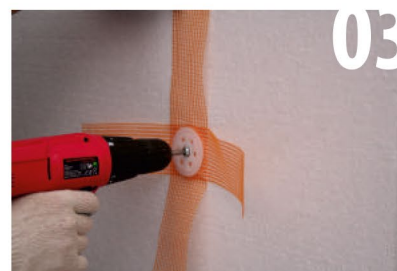
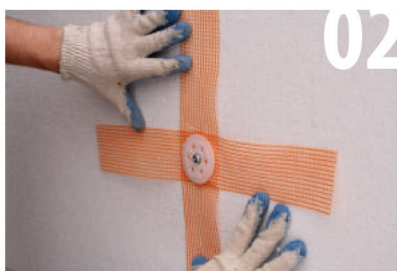
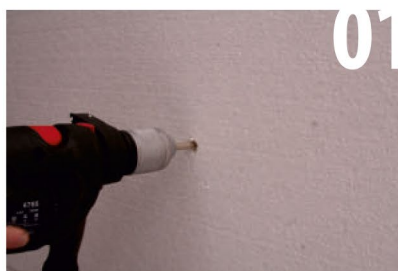

VIDEO

SOLTHERM CROSS KNOT FIXING

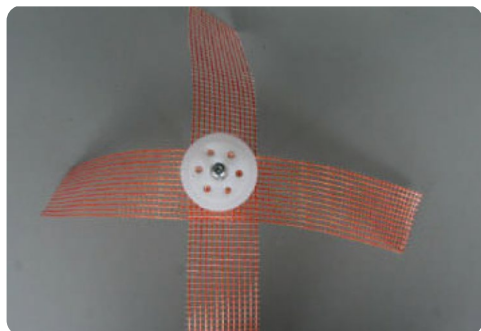

TECHNICAL DATA

HOLE DIAMETER
SUPPORT WASHER DIAMETER
PLUG MATERIAL
PIN TYPE AND MATERIAL

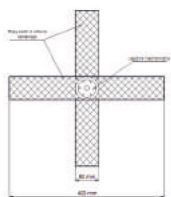

CROSS-KNOT

8 mm
60; 400 mm mesh strips
PE
STAINLESS OR GALVANIZED STEEL SCREW,
PRE-MOUNTED FOR QUICK INSTALLATION
(DOUBLE THREAD)

R-TFIX-8S, STR U 2G, THERMOTRIVE V2

8 mm
60 mm
PP
GALVANIZED CARBON STEEL
WITH PA HEAD REINFORCED
WITH GLASS FIBRE

FIXING DIMENSIONS

CODE	DIAMETER x LENGTH (MM)	PCS PER PACKAGE
cross knot 115	8x115	100
cross knot 135	8x135	100
cross knot 155	8x155	100
cross knot 175	8x175	100
cross knot 195	8x195	100
cross knot 215	8x215	100
cross knot 235	8x235	100
cross knot 255	8x255	100
cross knot 275	8x275	100
cross knot 295	8x295	100

FIXING DIMENSIONS

CODE	DIAMETER x LENGTH (MM)	PCS PER PACKAGE
cross knot 315	8x315	100
cross knot 335	8x335	100
cross knot 355	8x355	100
cross knot 375	8x375	100
cross knot 395	8x395	100
cross knot 415	8x415	100
cross knot 435	8x435	100
cross knot 455	8x455	100

INSULANT

INSULANT	CROSS-KNOT
EPS	•
XPS	•
MINERAL WOOL	•
LAMELLA	•

SUBSTRATE

SUBSTRATE	CROSS-KNOT
A	•
B	•
C	•
D	•
E	•

FIBREGLASS MESH

ALKALI RESISTANT FIBREGLASS MESH FOR REINFORCING BASE COAT WITHIN ETICS THERMAL INSULATION SYSTEMS

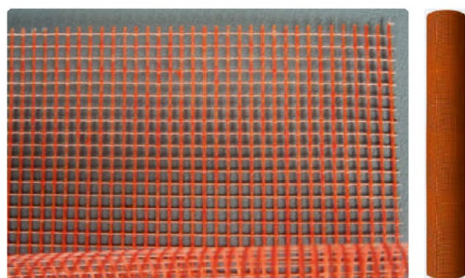

TECHNICAL DATA

MESH SIZE [MM]
WEIGHT [G]
WIDTH [CM]
ESTIMATED COVERAGE [M²/M²]
PACKAGE [M²]
TECHNICAL APPROVAL
PCS PER PACKAGE
COLOUR

SOLTHERM HD 158/S

3.9 x 4.0
158±8
110
1.1
55
ETA-16/0714
1 Roll
Orange

ARMOUR MESH

ALKALI RESISTANT FIBREGLASS MESH APPLIED WITH STANDARD MESH TO INCREASE IMPACT RESISTANCE OF ETICS THERMAL INSULATION SYSTEMS, IN BOLIX HD SYSTEM IN PARTICULAR

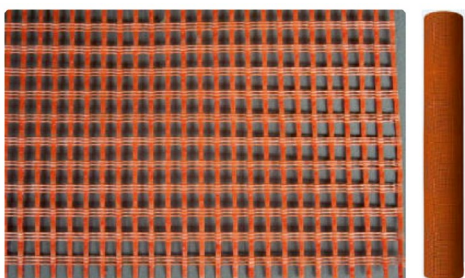

TECHNICAL DATA

MESH SIZE [MM]
WEIGHT [G/M²]
WIDTH [CM]
ESTIMATED COVERAGE [M²/M²]
PACKAGE [M²]
TECHNICAL APPROVAL
PCS PER PACKAGE
COLOUR

BOLIX HD 335/P

4.7 x 5.6
367±18
100
1.0
25
ETA-16/0714
1 Roll
Orange



PROFILES & BEADS



ARCHWAY CORNER BEAD

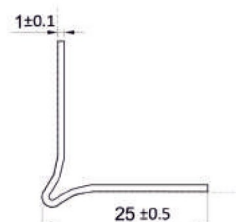
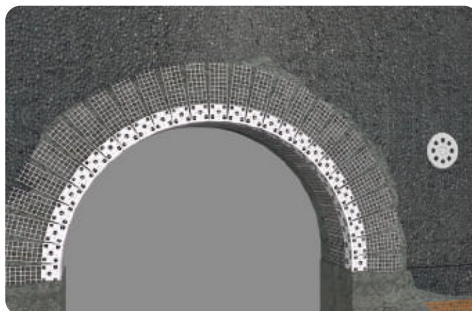
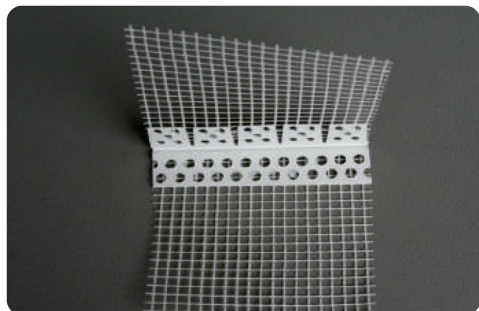

CODE	DIMENSION [MM]	MATERIAL	LENGHT [M]	PACKAGE [UNITS]
BX020	25x25x1 mesh 100x100	PVC	2.5	20

CHARACTERISTICS:

- suitable for ETICS
- used to reinforce arch corners and produce any angles created by curved walls and archways
- protects edges against mechanical damage
- perforations on both sides assure excellent adhesion to finishing compound or adhesive
- easy to produce arches and curves by cutting mesh attached to the profile
- attached glass fibre mesh of weight 145 g/m²

UNIVERSAL ANGLE BEAD

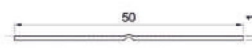
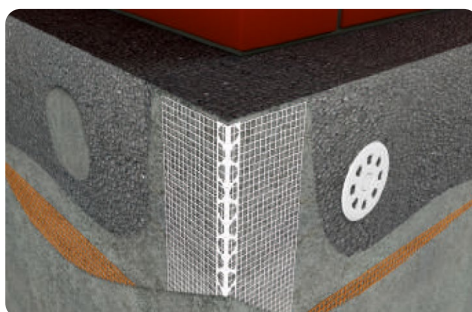
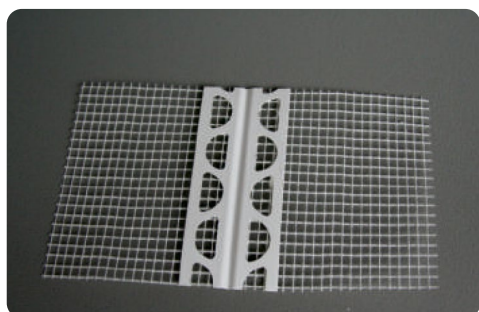

CODE	DIMENSION [MM]	MATERIAL	LENGHT [M]	PACKAGE [UNITS]
BX022	25x25x1 mesh 100x100	PVC	25	CARTON

CHARACTERISTICS:

- suitable for ETICS
- reinforces and provides aesthetic and true corners of more than 90°
- perfect as a corner, edge, door and window reveal protection against mechanical damage
- practical and easy to install
- comes in coils can be cut to size and no butt jointing of beads is necessary
- attached glass fibre mesh of weight 145 g/m²

CORNER BEAD

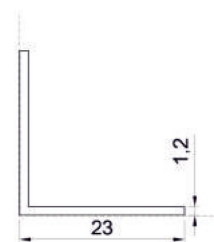
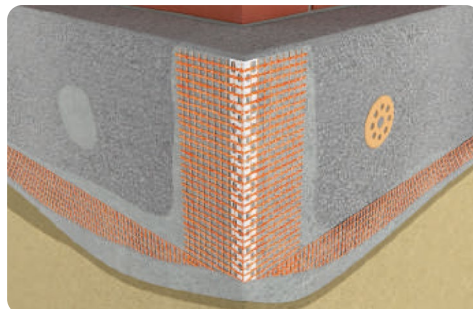
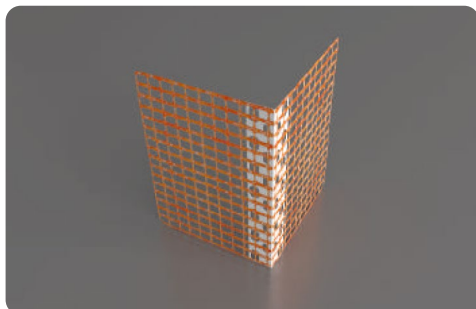

CODE	DIMENSION [MM]	MATERIAL	LENGTH [M]	PACKAGE [UNITS]
BX032	23x23 mesh 100x100	PVC	2.5	50
BX033	23x23 mesh 100x150	PVC	2.5	50

CHARACTERISTICS:

- suitable for ETICS
- forms crisp sharp clean outside corners
- reinforces and protects corners and edges from mechanical damages
- perforated flanges
- increases compressive strength of the joints
- easy and quick to install
- attached glass fibre mesh of weight 145 g/m²

CORNER BEAD WITH NOSE

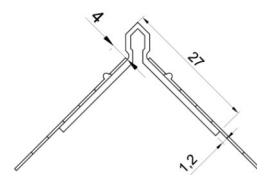
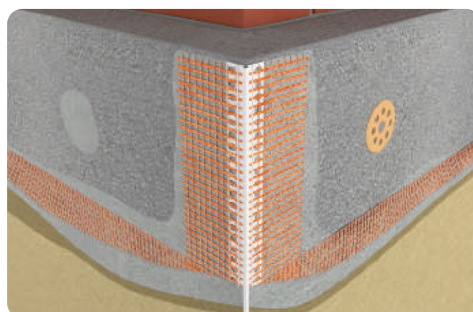
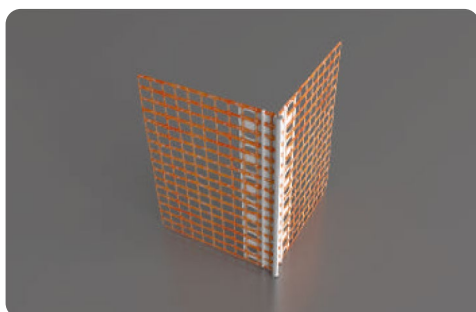

CODE	DIMENSION [MM]	MATERIAL	LENGTH [M]	PACKAGE [UNITS]
BX031	25x25x1 mesh 100x100	PVC	2.5	25

CHARACTERISTICS:

- suitable for ETICS
- protects and reinforces edges and forms perfectly even, crisp and sharp corners
- applied to the edge and fixed as suitable for render thickness
- sharp nose facilitates render smoothing
- perfect for exposed locations
- easy and quick to install
- chemically stable, not reacting with plaster
- attached glass fibre mesh of weight 145 g/m²

TRIMMING WINDOW PROFILE WITH REMOVABLE LEG

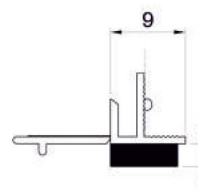
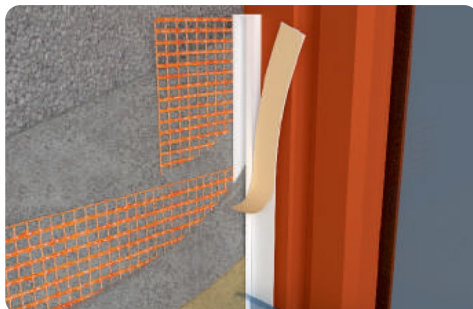
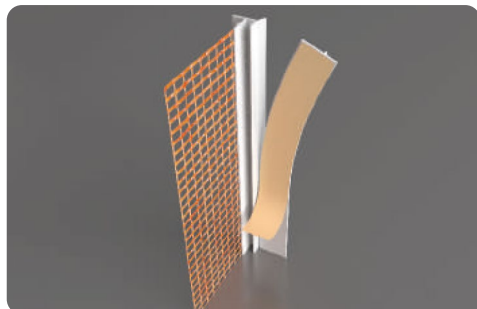

CODE	DIMENSION [MM]	MATERIAL	LENGTH [M]	PACKAGE [UNITS]
BX026	9	PVC	2.4	30

CHARACTERISTICS:

- suitable for ETICS
- provides an aesthetic finish for ETICS and a joining between external wall insulation systems and window/door frames
- shortens finish works, facilitates render application - even application
- sealing foam tape prevents crack formation and separation of the ETICS thermal insulation and the window frame, particularly at PVC windows
- forms durable and tight joint between insulation top coats and the window frame - damp and pollution penetration is eliminated
- facilitates window and glass protection against scratching and soiling during ETICS application
- double-sided self-adhesive removable leg enables masking foil application to the profile
- attached glass fibre mesh of weight 145 g/m²

TRIMMING WINDOW PROFILE WITH SEALING TAPE AND REMOVABLE LEG

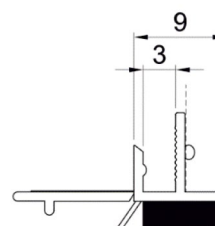
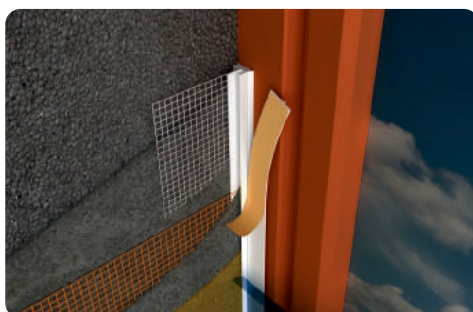
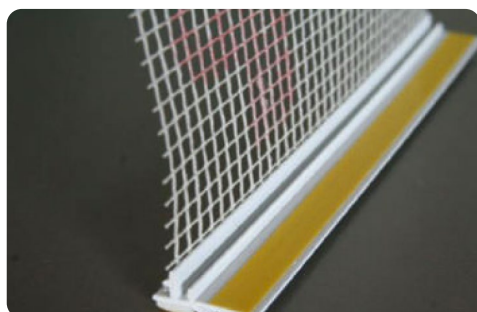

CODE	DIMENSION [MM]	MATERIAL	LENGTH [M]	PACKAGE [UNITS]
BX056	channel 6 mesh 100x100	PVC	2.6	50

CHARACTERISTICS:

- suitable for ETICS
- prevents crack formation at the joint between window reveal and render
- the sealing tape which additionally seals the joint with window/door reveal
- removable leg enables masking foil application and easy foil removal by breaking off the removable leg.
- window and glass protection against scratching and soiling during application operations

SILL AND REVEAL CONNECTION PROFILE

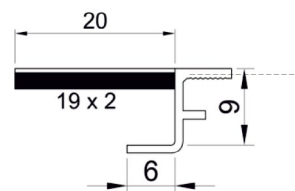
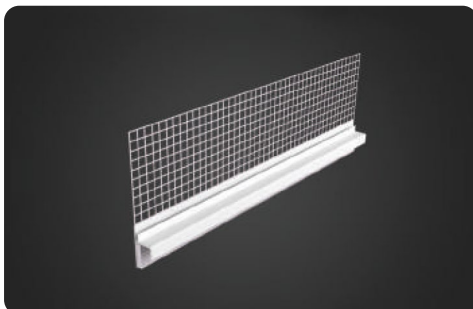

CODE	DIMENSION [MM]	MATERIAL	LENGHT [M]	PACKAGE [UNITS]
BX053	6 mesh 100	PVC	2	30

CHARACTERISTICS:

- suitable for ETICS
- allows water to drain away from the window reveal and prevents dripping of water from window sill through the joint under stucco
- designed to match metal sills with side lips
- provides sharp crisp and aesthetic window corners
- forms a strong control joint between the sill and render coating to prevent crack formation in the window frame
- apply a thin coat of MS polymer sealant to the side edge of the sill
- attached glass fibre mesh of weight 145 g/m²
- product protected by a patent

UNDER WINDOW SILL PROFILE

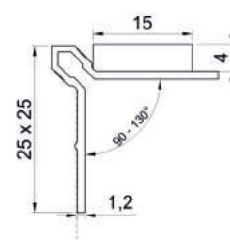
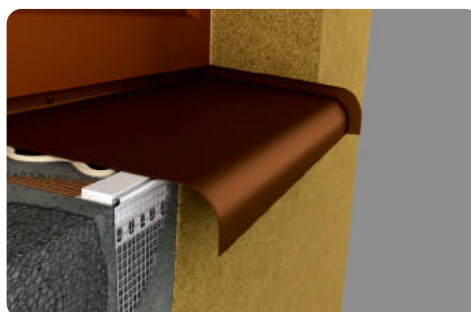
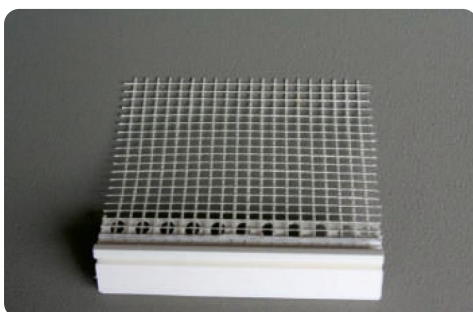

CODE	DIMENSION [MM]	MATERIAL	LENGHT [M]	PACKAGE [UNITS]
BX037	25x25	PVC	2	25

CHARACTERISTICS:

- suitable for ETICS
- provides a strong and uniform control joint between the sill and stucco
- 4mm PE foam tape eliminates crack formation between the sill and stucco by relieving stress caused by stucco shrinkage and thermal movement
- provides sharp crisp and aesthetic window corners
- can be flexed to fit the angle between the sill and wall
- adjustable flanges to fit angles between 90° - 130°
- facilitates sill fixing by attaching it to the foam, which provides damp proof control joint
- easy and quick to install
- attached glass fibre mesh of weight 145 g/m²

DRIP EDGE PROFILE

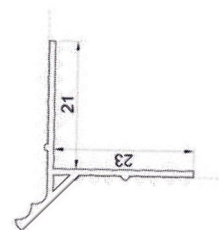
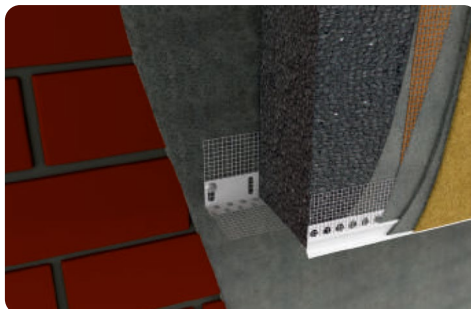
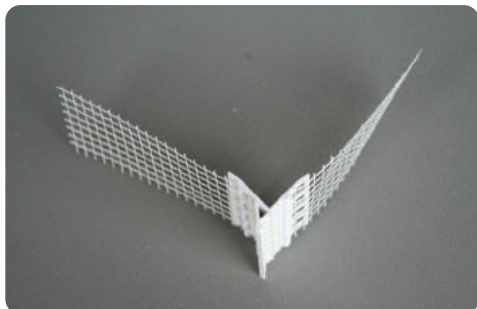

CODE	DIMENSION (MM)	MATERIAL	LENGHT (M)	PACKAGE (UNITS)
BX023	21x23 mesh 100x100	PVC	2	25

CHARACTERISTICS:

- suitable for ETICS
- element of the set for ETICS base
- reinforces and provides sharp crisp and aesthetic window and bottom edges
- allows water to move away from the building façade e.g. balconies, ledges, terraces, top jambs, base course
- easy and quick to install
- attached glass fibre mesh of weight 145 g/m²

EXTENDED DRIP EDGE PROFILE WITH MASKING BAND

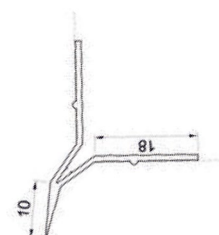
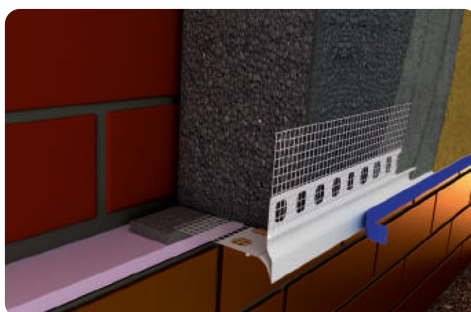
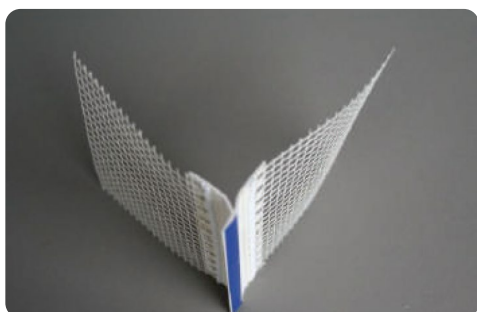

CODE	DIMENSION (MM)	MATERIAL	LENGHT (M)	PACKAGE (UNITS)
BX027	18x18 mesh 100x100	PVC	2.5	25

CHARACTERISTICS:

- suitable for ETICS
- prevents water to run under the thermal insulation e.g. door/window top jambs, balconies, ledges, terraces, base courses etc.
- masking band protected
- protects edges against mechanical damage
- provides a finished and attractive look by forming a crisp and neat edge at building base
- easy and quick to install
- attached glass fibre mesh of weight 145 g/m²

DRIP EDGE PROFILE

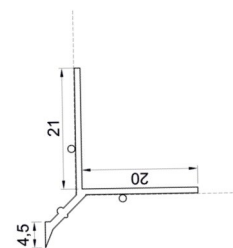
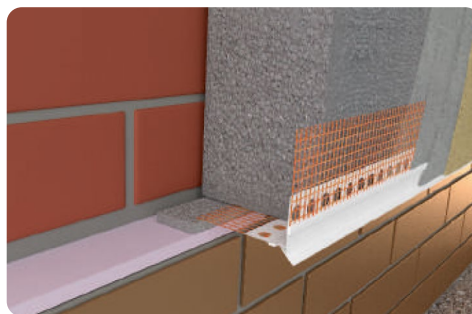
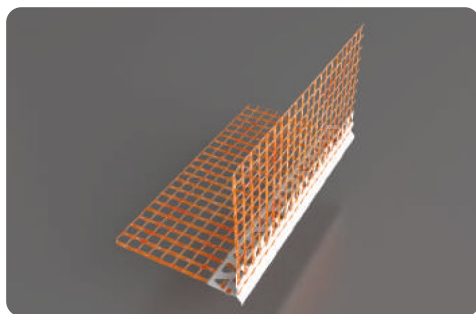

CODE	DIMENSION [MM]	MATERIAL	LENGHT [M]	PACKAGE [UNITS]
BX029	20x20 mesh 110x110	PVC	2,5	25

CHARACTERISTICS:

- suitable for ETICS
- prevents flow of rain water down to the façade
- prevents water ingress under stucco e.g. door/window top jambs, balconies, ledges, terraces, base courses etc.
- protects edges against mechanical damage
- provides a finished and attractive look by forming crisp and neat edge at building base
- easy and quick to install
- attached glass fibre mesh of weight 145 g/m²

L STOP BEAD

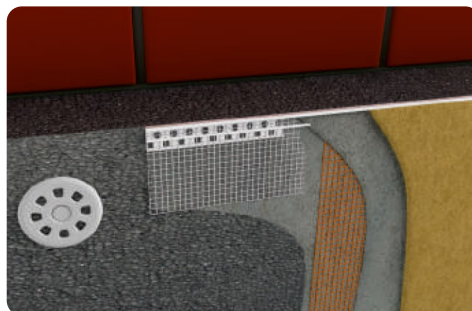

CODE	DIMENSION [MM]	MATERIAL	LENGHT [M]	PACKAGE [UNITS]
BX044	3	PVC	2	25
BX048	10	PVC	2	25
BX050	15	PVC	2	25

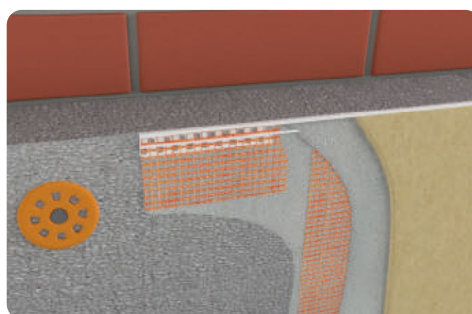
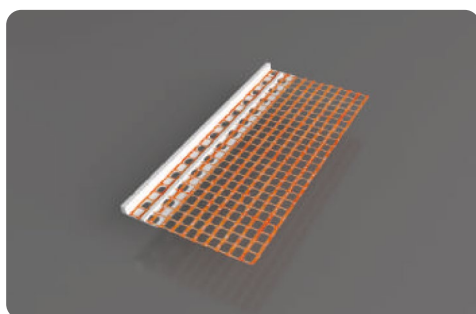
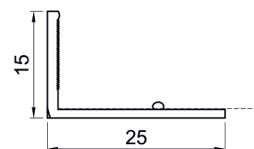
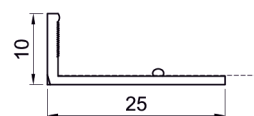
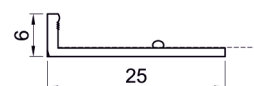
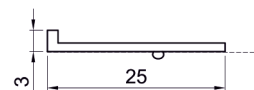

CODE	DIMENSION [MM]	MATERIAL	LENGHT [M]	PACKAGE [UNITS]
BX046	6	PVC	2	25

CHARACTERISTICS:

- suitable for ETICS
- enables seaming of various finish coats and smooth transition between them
- enables render termination and seaming of abutting render finish coats applied in different operations
- provides a flush render finish
- render coat thickness matching bead size
- easy and quick to install, shortens finishing works
- attached glass fibre mesh of weight 145 g/m²

SURFACE MOVEMENT BEAD

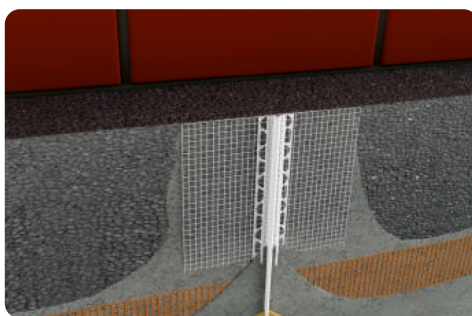
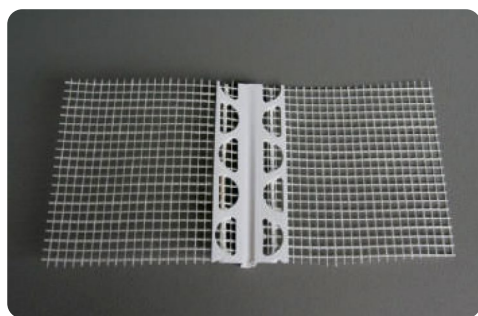

CODE	DIMENSION [MM]	MATERIAL	LENGHT [M]	PACKAGE [UNITS]
BX038	7 mesh 100x100	PVC	2.5	25

CHARACTERISTICS:

- suitable for ETICS
- prevents crack formation due to stucco thermal movement
- fills and seals control joint to protect against water ingress under stucco
- provides a sharp neat and aesthetic movement joint edges
- provides long-lasting seal and resistance to weather factors
- protects against damp and dirt penetration of thermal insulation
- made of bendable PVC
- attached glass fibre mesh of weight 145 g/m²

FULL EXPANSION JOINT PROFILE E-TYPE

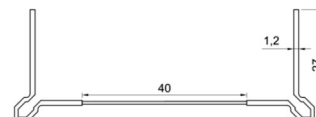
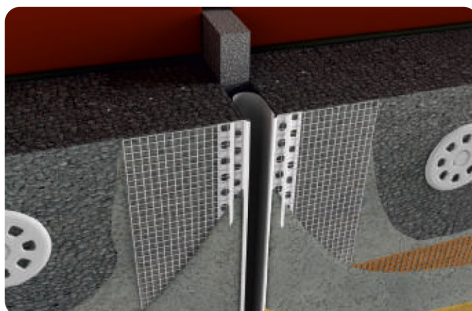
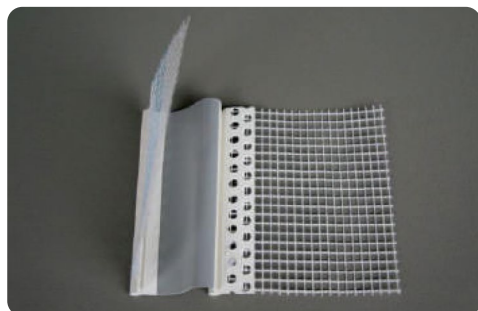

CODE	DIMENSION [MM]	MATERIAL	LENGHT [M]	PACKAGE [UNITS]
BX040	elastomer 40 mesh 100x100	PVC	2	25

CHARACTERISTICS:

- suitable for ETICS
- forms structural expansion joints between 10-30 mm
- prevents crack formation due to thermal movement
- fills and seals expansion joint to protect against water ingress under thermal insulation
- provides a finished expansion joint edges
- provides long-lasting seal and resistance to weather factors
- protects against damp and dirt penetration of thermal insulation
- attached glass fibre mesh of weight 145 g/m²

FULL EXPANSION JOINT PROFILE FOR INTERNAL CORNERS V-TYPE

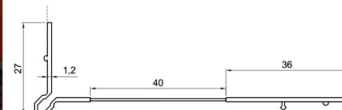
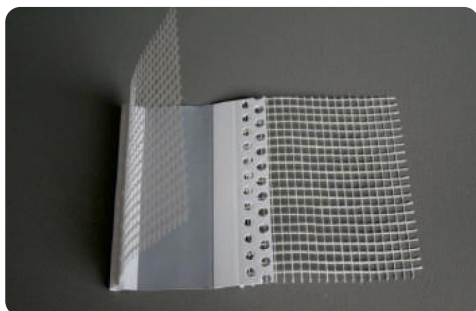

CODE	DIMENSION [MM]	MATERIAL	LENGHT [M]	PACKAGE [UNITS]
BX041	elastomer 40 mesh 100x100	PVC	2	25

CHARACTERISTICS:

- suitable for ETICS
- forms structural expansion joints between 10-30mm
- prevents crack formation due to thermal movement
- fills and seals expansion joint to protect against water ingress under thermal insulation
- provides a sharp neat and finished expansion joint edges
- provides long-lasting seal and resistance to weather factors
- attached glass fibre mesh of weight 145 g/m²

FULL EXPANSION MOVEMENT JOINT BEAD

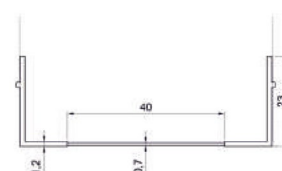
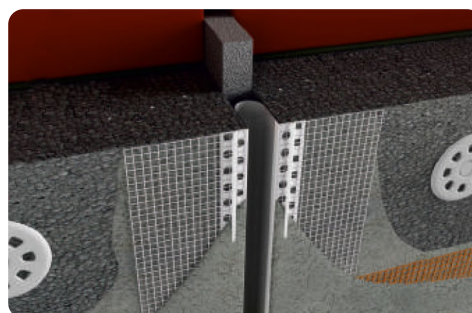
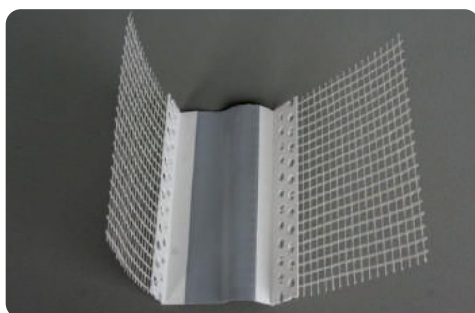

CODE	DIMENSION [MM]	MATERIAL	LENGHT [M]	PACKAGE [UNITS]
BX042	elastomer 40 mesh 110x110	PVC	2.5	25

CHARACTERISTICS:

- suitable for ETICS
- prevents crack formation due to thermal movement
- fills and seals expansion joint to protect against water ingress under thermal insulation
- provides a sharp neat and finished expansion joint edges
- forms structural expansion joints between 10-30mm
- provides long-lasting seal and resistance to weather factors
- attached glass fibre mesh of weight 145 g/m²

FULL MOVEMENT JOINT BEAD FOR INNER CORNERS

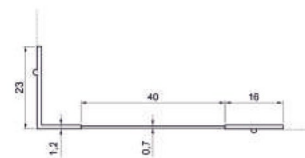
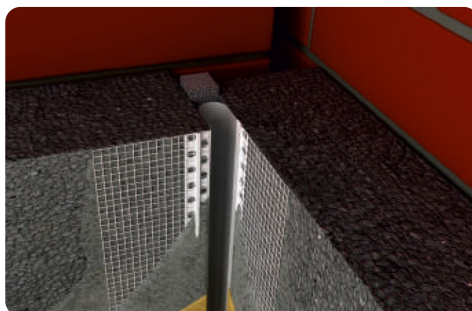
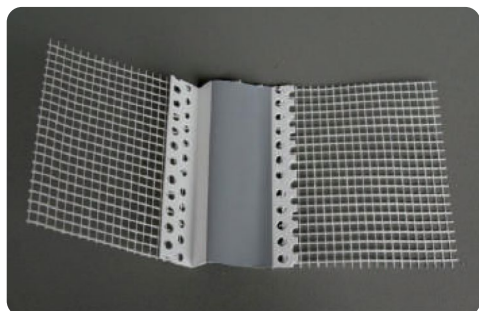

CODE	DIMENSION [MM]	MATERIAL	LENGHT [M]	PACKAGE [UNITS]
BX043	elastomer 40 mesh 110x110	PVC	2.5	25

CHARACTERISTICS:

- suitable for ETICS
- prevents crack formation due to thermal movement
- fills and seals expansion joint to protect against water ingress under thermal insulation
- provides a sharp neat and finished expansion joint edges
- forms structural expansion joints between 10-30mm and provides continuous expansion joint
- provides long-lasting seal and resistance to weather factors
- attached glass fibre mesh of weight 145 g/m²

GROOVE PROFILE WITH MESH

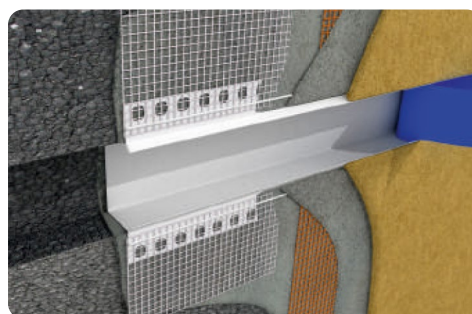
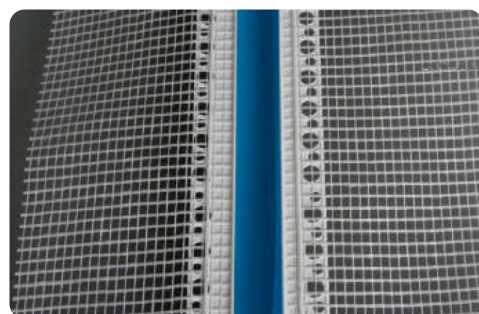

CODE	DIMENSION [MM]	MATERIAL	LENGHT [M]	PACKAGE [UNITS]
BX010	width: 10mm depth: 10mm	PVC	3	20
BX011	width: 20mm depth: 20mm	PVC	3	20
BX012	width: 30mm depth: 20mm	PVC	3	20
BX013	width: 50mm depth: 20mm	PVC	3	20

CHARACTERISTICS:

- create neat and even aesthetic breaks in stucco
- reinforces stucco breaks
- perfect finish effect of stone cladding, cheap and easy since it eliminates the anchoring of heavy stone panels
- provides rustication effect in a cheap and quick way
- forms crisp and neat groove edges
- can be overcoated with exterior paints of any colour
- resistant to weather factors and does not react with building chemistry products
- decorative element
- attached glass fibre mesh of weight 145 g/m²

GROOVE PROFILE CONNECTOR

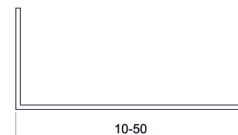
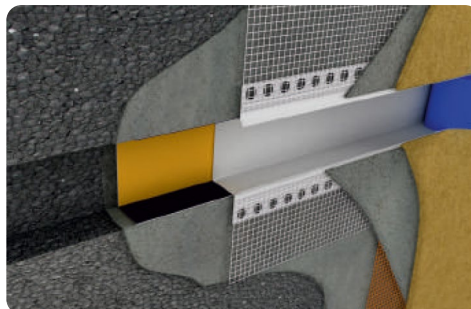
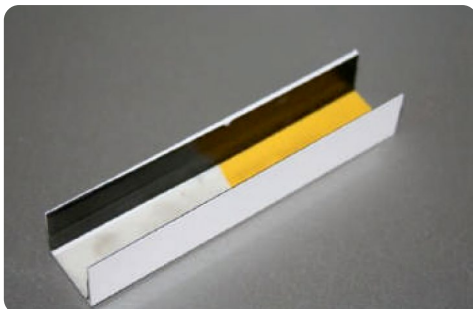

CODE	DIMENSION [MM]	MATERIAL	LENGTH [M]	PACKAGE [UNITS]
BX014	connector 1 cm	PVC	-	40
BX015	connector 2 cm	PVC	-	40
BX016	connector 3 cm	PVC	-	40
BX017	connector 5 cm	PVC	-	40

CHARACTERISTICS:

- makes tight and long-lasting butt joints between reveal trims as well as reveal trims and inside corner trims
- aesthetic butt joints
- sized to match reveal trims
- comes with special non-absorbent white foam strip and non-absorbent black gaskets

CORNER GROOVE PROFILE

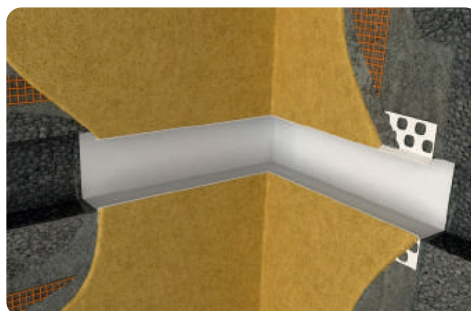

CODE	DIMENSION [MM]	MATERIAL	TYPE	PACKAGE [UNITS]
BX018	width: 30mm depth: 30mm	PVC	internal	10
BX019	width: 30mm depth: 30mm	PVC	external	10

CHARACTERISTICS:

- creates inside or outside corner at the joining of stucco breaks
- inside or outside corner trim
- seals and tightens trim joints on the building corners
- compensates for uneven cut of trims
- provides attractive finish and increases usable life of stucco
- use dedicated fasteners to join the reveal trim with the corner reveal trim
- suitable for reveal trims with and without mesh

MESH GROOVES PROFILES

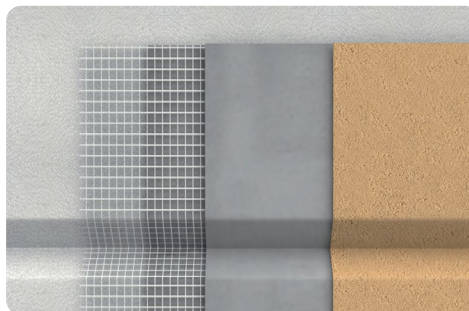
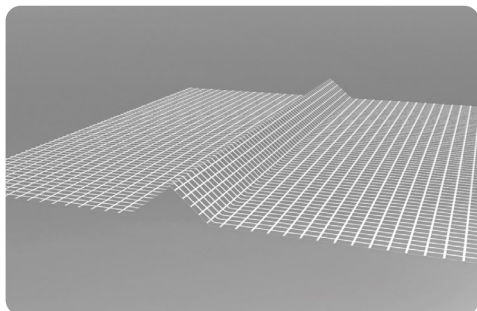

CODE	DIMENSION [MM]	MATERIAL	LENGTH [M]	PACKAGE [UNITS]
LBP-V1	elastomer 40 mesh 100x100	glass fibre mesh 160g/m ²	2	25

CHARACTERISTICS:

- creates an aesthetically perfect finish
- the grooves allow the creation of ideally straight lines
- the grooves are protected against weather effects
- easy and time saving application
- 10 cm wide wings for perfect connection to the surface

TECHNICAL DATA

MESH SIZE [MM]
WEIGHT [G]
WIDTH [CM]
PACKAGE [M²]
COLOUR

SOLTHERM HD 158/S

size 3.0 x 1.7
160
24
20
white

MESH GROOVE OUTER CORNER

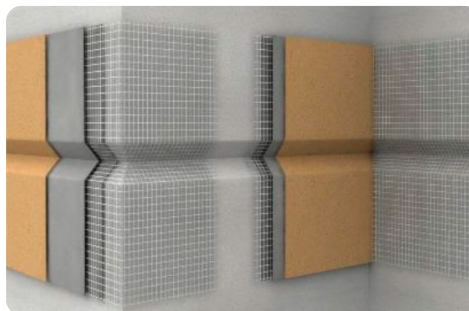
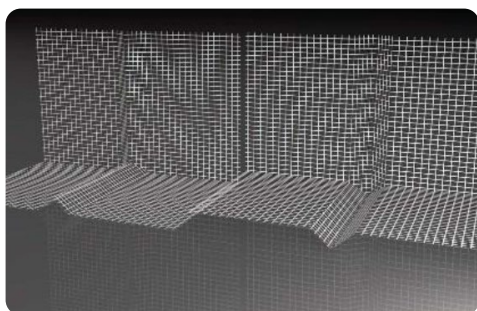

CODE	DIMENSION [MM]	MATERIAL	LENGTH [M]	PACKAGE [UNITS]
LBP-V1	100 x 100	glass fibre mesh 160g/m ²	240	10

CHARACTERISTICS:

Fabric bossage corners for creation and reinforcement of bossage in and at wall corners in the thermal insulation system - ETICS.

TECHNICAL DATA

MESH SIZE [MM]
WEIGHT [g]
WIDTH [cm]
PACKAGE [m²]
COLOUR

LBP-V1

3.0x1.7
160
24
20
WHITE

MESH GROOVE INNER CORNER

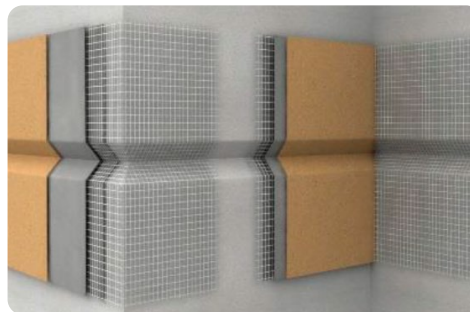
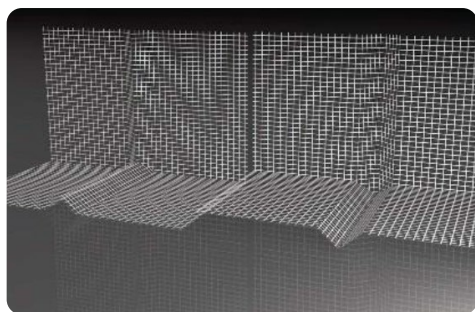

CODE	DIMENSION [MM]	MATERIAL	LENGTH [M]	PACKAGE [UNITS]
LBP-V2	100 x 100	glass fibre mesh 160g/m ²	240	10

CHARACTERISTICS:

Cross mesh groove profile for reinforcement of bossage groove intersection in the thermal insulation system - ETICS.

TECHNICAL DATA

MESH SIZE [MM]
WEIGHT [g]
WIDTH [cm]
PACKAGE [m²]
COLOUR

LBP-V2

3.0x1.7
160
24
20
WHITE

MESH GROOVE CROSS

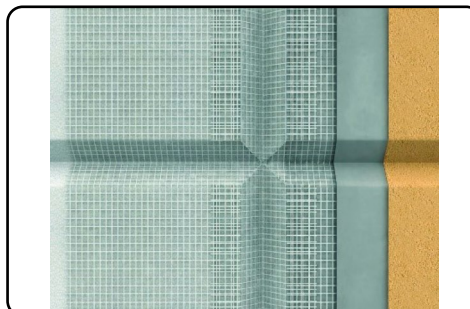
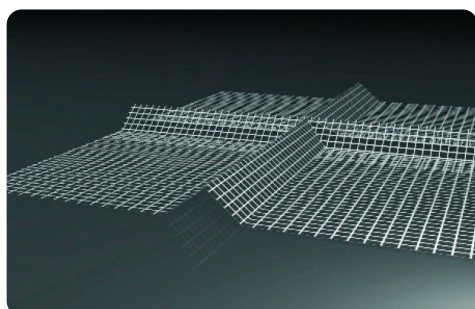

CODE	DIMENSION [MM]	MATERIAL	LENGTH [M]	PACKAGE [UNITS]
LBP-V3	190	glass fibre mesh 160g/m ²	240	25

CHARACTERISTICS:

TECHNICAL DATA

MESH SIZE [MM]
WEIGHT [g]
WIDTH [cm]
PACKAGE [m²]
COLOUR

LBP-V3

3.0x1.7
160
24
20
WHITE

ALUMINIUM STARTER TRACK

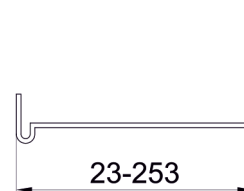
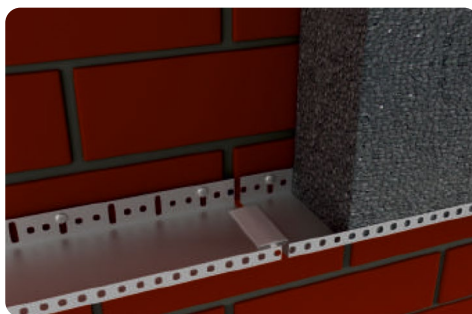
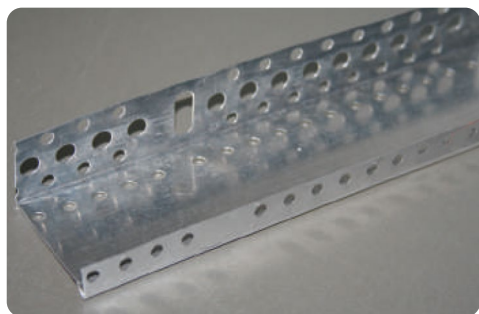

CODE	DIMENSION [MM]	MATERIAL	LENGHT [M]	PACKAGE [UNITS]
BX096	wide: 33mm thick 0.8mm	ALU	2.5	20
BX097	wide: 43mm thick 0.8mm	ALU	2.5	20
BX098	wide: 53mm thick 0.8mm	ALU	2.5	20
BX099	wide: 63mm thick 0.8mm	ALU	2.5	20
BX100	wide: 73mm thick 0.8mm	ALU	2.5	20
BX101	wide: 83mm thick 0.8mm	ALU	2.5	20
BX102	wide: 103mm thick 0.8mm	ALU	2.5	20
BX103	wide: 123mm thick 0.8mm	ALU	2.5	20
BX104	wide: 143mm thick 0.8mm	ALU	2.5	10
BX105	wide: 153mm thick 0.8mm	ALU	1.0	10
BX106	wide: 163mm thick 0.8mm	ALU	1.0	20
BX107	wide: 183mm thick 0.8mm	ALU	1.0	20
BX108	wide: 203mm thick 0.8mm	ALU	1.0	20
BX109	wide: 223mm thick 0.8mm	ALU	1.0	20
BX110	wide: 253mm thick 0.8mm	ALU	1.0	20

CHARACTERISTICS:

- suitable for ETICS
- bottom runner to secure proper board fixing
- protects bottom external insulation systems from mice or rats and mechanical damage
- prevent air flow between wall and thermal insulation
- available in various thickness AL and for various thickness of thermal insulation
- **AVAILABLE in 0,6 mm and 1 mm**

CLIP-ON BEAD ALUMINIUM STARTER TRACK

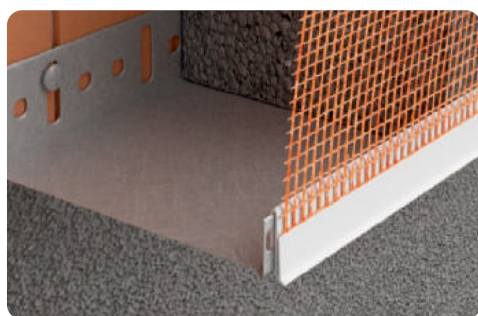

CHARACTERISTICS:

- Eliminates cracking and damage at the base sections of the ETICS system
- Draining of water from plaster Avoid capillary action of moisture beneath the plaster
- Easy installation

CODE	DIMENSION [MM]	MATERIAL	LENGHT [M]	PACKAGE [UNITS]
BX111	3	PVC	2.5	20

HAMMER-IN STARTER TRACK FIXING

PACKAGE 100 PCS.



CODE	DIAMETERX LENGHT	PCS PER PACKAGE
FX-06L060	6x60	100PCS
FX-06L080	6x80	100PCS
FX-08L060	8x60	100PCS
FX-08L080	8x80	50PCS

BASE TRACK CONNECTOR CLIP

PACKAGE 100 PCS.



BELLCAST PROFILES



CHARACTERISTICS:

- Eliminates cracking and damage at the base sections of the ETICS system
- Draining of water from plaster Avoid capillary action of moisture beneath the plaster
- Easy installation

CODE	THICKNESS	DIAMETERX LENGHT	PCS PER PACKAGE
PLS	10mm	2,5mx3,5m	34pcs
PLS	15mm	2,5mx3,5m	34pcs
PLS	20mm	2,5mx3,5m	34pcs

PAL R PROFILES

BALCONY PROFILE

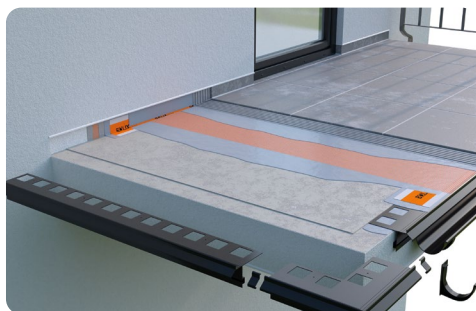

131



132

126



CODE	DIMENSION [MM]	MATERIAL	LENGHT [M]	PACKAGE [UNITS]
BX041	elastomer 40 mesh 100x100	PVC	2	25

CODE		DIMENSION [MM]	MATERIAL	PACKAGE [UNITS]
BX126	PAL-R	2000x135	ALU	pcs
BX127	PAL-R90Z	265x135	ALU	pcs
BX128	PAL-R90W	278x135	ALU	pcs
BX129	PAL-R135Z	221x135	ALU	pcs
BX130	PAL-R135W	152x135	ALU	pcs
BX131	LAL-PALRC		ALU	pcs
BX132	OAL-PALRF		ALU	pcs

127



PAL PROFILES

BALCONY PROFILE

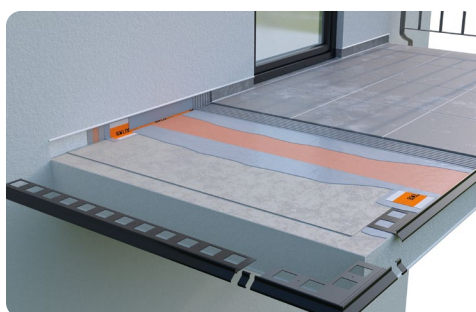

156



155

CODE	DIMENSION [MM]	MATERIAL	LENGHT [M]	PACKAGE [UNITS]
BX041	elastomer 40 mesh 100x100	PVC	2	25

CODE		DIMENSION [MM]	MATERIAL	PACKAGE [UNITS]
BX150	PAL	2000x110	ALU	pcs
BX151	PAL 90Z	265x110	ALU	pcs
BX152	PAL 90W	278x110	ALU	pcs
BX153	PAL 135Z	221x110	ALU	pcs
BX154	PAL 135W	152x110	ALU	pcs
BX155	PAL C		ALU	pcs
BX156	PAL RF		ALU	



151

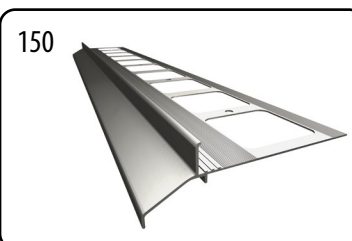

150

PAL 100 PROFILES

BALCONY PROFILE

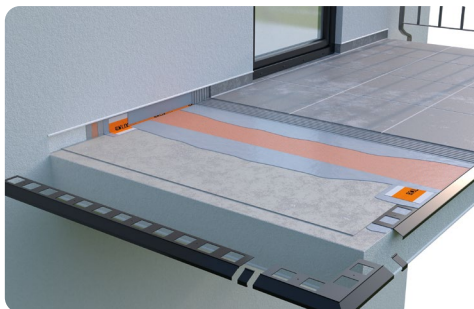

117



113

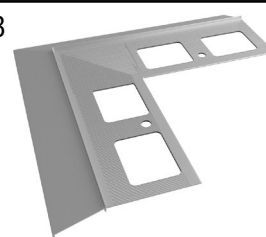

112

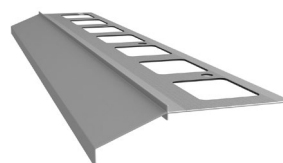

118

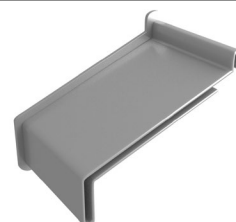

CODE	DIMENSION [MM]	MATERIAL	LENGHT [M]	PACKAGE [UNITS]
BX041	elastomer 40 mesh 100x100	PVC	2	25

CODE		DIMENSION [MM]	MATERIAL	PACKAGE [UNITS]
BX112	PAL-100	2000x110	ALU	pcs
BX113	PAL-100 90Z	265x110	ALU	pcs
BX114	PAL-100 90W	278x110	ALU	pcs
BX115	PAL-100 135Z	221x110	ALU	pcs
BX116	PAL-100 135W	152x110	ALU	pcs
BX117	PAL-100C		ALU	pcs
BX118	PAL-100F		ALU	

PAL E PROFILES

BALCONY PROFILE

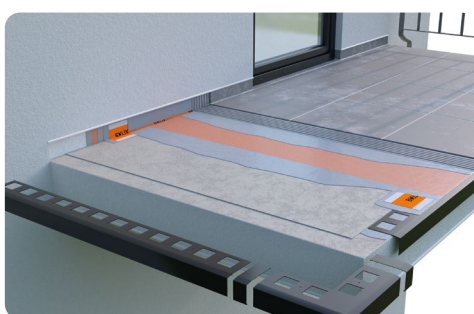

124



120

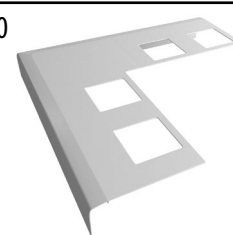

113

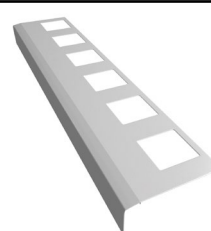

125



CODE	DIMENSION [MM]	MATERIAL	LENGHT [M]	PACKAGE [UNITS]
BX041	elastomer 40 mesh 100x100	PVC	2	25

CODE		DIMENSION [MM]	MATERIAL	PACKAGE [UNITS]
BX119	PAL-E	2000x100	ALU	pcs
BX120	PAL-E90Z	250x100	ALU	pcs
BX121	PAL-E90W	250x100	ALU	pcs
BX122	PAL-E135Z	190x100	ALU	pcs
BX123	PAL-E135W	150x100	ALU	pcs
BX124	LAL-PALEC		ALU	pcs
BX125	OAL-PALEF		ALU	pcs

W 35 PROFILES

BALCONY PROFILE

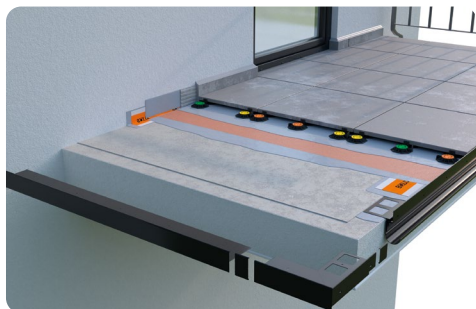

146-143



141



142



CODE	DIMENSION [MM]	MATERIAL	LENGHT [M]	PACKAGE [UNITS]
BX041	elastomer 40 mesh 100x100	PVC	2	25

CODE		DIMENSION [MM]	MATERIAL	PACKAGE [UNITS]
BX133	PAL-W35	2000x98	ALU	pcs
BX134	PAL-W35B	2000x98	ALU	pcs
BX135	PAL-W35-90Z	240x98	ALU	pcs
BX136	PAL-W35-135Z	180x98	ALU	pcs
BX137	PAL-W35-90W		ALU	pcs
BX138	PAL-W35-135W		ALU	pcs
BX139	PAL-W35W35B-90PRA		ALU	pcs
BX140	PAL-W35W35B-90LEW		ALU	pcs
BX141	PAL-LW35		ALU	pcs
BX142	PAL-LW35B		ALU	pcs
BX143	X			
BX144	X			
BX145	PAL-W PT [35]			
BX146	X			
BX147	X			
BX148	X			
BX149	X			

135

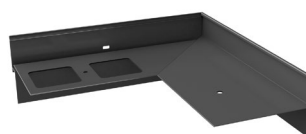

134

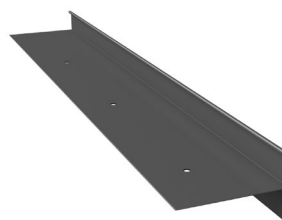

145

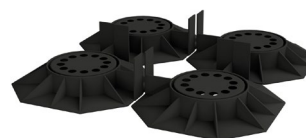

133

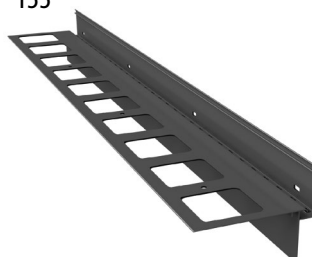



TOOLS



STAINLESS STEEL PLASTERERS' TROWEL



ITEM	ARTICLE NAME	CODE	PCS PER PACKAGE [UNITS]
1	Stainless trowel with rubber handle 270x128	TBN001	24

STAINLESS STEEL PROFESSIONAL PLASTERERS' NOTCHED TROWEL,,EXPERT'



ITEM	ARTICLE NAME	CODE	PCS PER PACKAGE [UNITS]
2	Stainless notched trowel 270x128 wooden ruben handle 4x4	TBN002	24
3	Stainless notched trowel 270x128 wooden ruben handle 6x6	TBN003	24
4	Stainless notched trowel 270x128 wooden ruben handle 8x8	TBN004	24
5	Stainless notched trowel 270x128 wooden ruben handle 10x10	TBN005	24
6	Stainless notched trowel 270x128 wooden ruben handle 12x12	TBN006	24

STAINLESS STEEL FLOAT



ITEM	ARTICLE NAME	CODE	PCS PER PACKAGE [UNITS]
7	Stainless notched trowel 480mm with plastic handle	TBN007	10

PLASTIC TROWEL



ITEM	ARTICLE NAME	CODE	PCS PER PACKAGE [UNITS]
8	Smooth plastic trowel 280x140 abs	TBN008	10

HAND SANDER



ITEM	ARTICLE NAME	CODE	PCS PER PACKAGE [UNITS]
9	Abrasive trowel with latch 210x105	TBN009	30

RUBBER FLOAT



ITEM	ARTICLE NAME	CODE	PCS PER PACKAGE [UNITS]
10	Pcv trowel with rubber 270x130	TBN010	10

RUBBER SPONGE FLOAT



ITEM	ARTICLE NAME	CODE	PCS PER PACKAGE [UNITS]
11	Pcv trowel with sponge 270x130	TBN011	10

ABRASIVE RASP



ITEM	ARTICLE NAME	CODE	PCS PER PACKAGE [UNITS]
12	Metal rasp trowel 400x180	TBN012	10

ABRASIVE RASP



ITEM	ARTICLE NAME	CODE	PCS PER PACKAGE [UNITS]
13	Metal rasp trowel 270x130	TBN013	20

STAINLESS STEEL FLOAT



ITEM	ARTICLE NAME	CODE	PCS PER PACKAGE [UNITS]
14	Stainless trowel with wooden handle 680mm	TBN014	18
15	Stainless trowel with wooden handle 580mm	TBN015	18

STAINLESS STEEL PUTTY KNIFE STAINLESS STEEL PUTTY KNIFE



ITEM	ARTICLE NAME	CODE	PCS PER PACKAGE [UNITS]
16	Stainless paint spatula 100mm	TBN016	20
17	Stainless paint spatula 40mm	TBN017	20
18	Stainless paint spatula 60mm	TBN018	20
19	Stainless paint spatula 80mm	TBN019	20



ITEM	ARTICLE NAME	CODE	PCS PER PACKAGE [UNITS]
20	Stainless spatula 150x90	TBN020	10

STAINLESS STEEL TAPING KNIFE



ITEM	ARTICLE NAME	CODE	PCS PER PACKAGE [UNITS]
21	Stainless spatula for facades 350mm with rubber handle	TBN021	10
22	Stainless spatula for facades 550mm with rubber handle	TBN022	10
23	Stainless spatula for facades 600mm with rubber handle	TBN023	10

STAINLESS STEEL COMBINATION TOOL



ITEM	ARTICLE NAME	CODE	PCS PER PACKAGE [UNITS]
24	Stainless universal painter's spatula	TBN024	20

BUCKET TROWEL, STAINLESS STEEL



ITEM	ARTICLE NAME	CODE	PCS PER PACKAGE [UNITS]
25	Stainless bucket trowel 120mm	TBN025	50
26	Stainless bucket trowel 140mm	TBN026	50
27	Stainless bucket trowel 160mm	TBN027	50

MORTAR MIXING PADDLE



ITEM	ARTICLE NAME	CODE	PCS PER PACKAGE [UNITS]
28	Mortar mixing paddle 80mm	TBN028	50
29	Mortar mixing paddle 100mm	TBN029	40
30	Mortar mixing paddle 120x600x14	TBN030	20

PAINT MIXING PADDLE



ITEM	ARTICLE NAME	CODE	PCS PER PACKAGE [UNITS]
31	Paint mixing paddle 60mm	TBN031	50
32	Paint mixing paddle 80mm	TBN032	50

FEATHEREDGE DARBY



ITEM	ARTICLE NAME	CODE	PCS PER PACKAGE [UNITS]
33	Trapezoidal traversing rule 100cm	TBN033	1
34	Trapezoidal traversing rule 150cm	TBN034	5
35	Trapezoidal traversing rule 200cm	TBN035	5
36	Trapezoidal traversing rule 240cm	TBN036	5

FINISHING DARBY



ITEM	ARTICLE NAME	CODE	PCS PER PACKAGE [UNITS]
37	Taversing rule type h 100cm	TBN037	1
38	Taversing rule type h 150cm	TBN038	4
39	Taversing rule type h 200cm	TBN039	4
40	Taversing rule type h 240cm	TBN040	4

PLASTIC BUCKET



ITEM	ARTICLE NAME	CODE	PCS PER PACKAGE [UNITS]
41	Round mortrar container 45l	TBN041	10
42	Round mortrar container 65l	TBN042	10
43	Round mortrar container 90l	TBN043	10

PLASTIC MORTAR BOX



ITEM	ARTICLE NAME	CODE	PCS PER PACKAGE [UNITS]
44	Mortrar container 40l	TBN044	10
45	Mortrar container 60l	TBN045	10
46	Mortrar container 80l	TBN046	10

GROUT BUCKET 16L



ITEM	ARTICLE NAME	CODE	PCS PER PACKAGE [UNITS]
47	Tiling bucket 20l	TBN047	-

ROLLS FOR BUCKET



ITEM	ARTICLE NAME	CODE	PCS PER PACKAGE [UNITS]
48	Twin wash toller for tiling bucket	TBN048	35

SPIKED AERATION ROLLER



ITEM	ARTICLE NAME	CODE	PCS PER PACKAGE [UNITS]
49	Spiked aeration roller 500mm	TBN049	2
50	Spiked aeration roller 700mm	TBN050	2

ROLLER HANDLE



ITEM	ARTICLE NAME	CODE	PCS PER PACKAGE [UNITS]
51	Roller handle 6x180	TBN51	100
52	Roller handle 8x180	TBN52	100

ROLLER COVER SYNTEX FACADE



ITEM	ARTICLE NAME	CODE	PCS PER PACKAGE [UNITS]
53	Syntex facade roller cover 190mm	TBN053	10
54	Syntex facade roller cover 250mm	TBN054	10

UNIVERSAL ROLLER GIRPAINT



ITEM	ARTICLE NAME	CODE	PCS PER PACKAGE [UNITS]
55	Universal roller cover 180mm	TBN055	10
56	Universal roller cover 250mm	TBN056	10

ROLLER COVER



ITEM	ARTICLE NAME	CODE	PCS PER PACKAGE [UNITS]
57	Roller cover velur 180mm	TBN057	10
58	Roller cover velur 250mm	TBN058	10

MIDI-SIZED ROLLER COVER GIRPAINT



ITEM	ARTICLE NAME	CODE	PCS PER PACKAGE [UNITS]
59	Universal midi roller cover 100mm	TBN059	50
60	Universal midi roller cover 120mm	TBN060	50

MIDI-SIZED ROLLER COVER



ITEM	ARTICLE NAME	CODE	PCS PER PACKAGE [UNITS]
61	Velur midi roller cover 100mm	TBN061	10
62	Velur midi roller cover 150mm	TBN062	10

ROLLER TRAY



ITEM	ARTICLE NAME	CODE	PCS PER PACKAGE [UNITS]
63	Paint tray 31x35	TBN063	50
64	Paint tray 24x32	TBN064	100
65	Paint tray 15x34	TBN065	150
66	Paint tray 12x19	TBN066	100
67	Paint tray 19x11	TBN067	10

ROLLER GRID



ITEM	ARTICLE NAME	CODE	PCS PER PACKAGE [UNITS]
68	Paint roller grid 22x26	TBN068	100
69	Paint roller grid 26x32	TBN069	100

ROUND PAINT BRUSH



ITEM	ARTICLE NAME	CODE	PCS PER PACKAGE [UNITS]
70	Round paint brush 20mm	BN070	12
71	Round paint brush 30mm	BN071	12
72	Round paint brush 40mm	BN072	12
73	Round paint brush 50mm	BN073	6
74	Round paint brush 60mm	BN074	6

ANGLE SASH BRUSH



ITEM	ARTICLE NAME	CODE	PCS PER PACKAGE [UNITS]
75	Angle sash brush „skośny” 18mm x 1,5	BN075	12
76	Angle sash brush „skośny” 18mm x 2	BN076	12
77	Angle sash brush „skośny” 18mm x 2,5	BN077	12
78	Angle sash brush „skośny” 18mm x 3	BN078	12

RADIATOR BRUSH



ITEM	ARTICLE NAME	CODE	PCS PER PACKAGE [UNITS]
79	Radiator Paint Brush 25	BN079	12
80	Radiator Paint Brush 36	BN080	12
81	Radiator Paint Brush 50	BN081	12
82	Radiator Paint Brush 63	BN082	12

CHIP BRUSH



ITEM	ARTICLE NAME	CODE	PCS PER PACKAGE [UNITS]
83	Flat Universal Paint Brush 30mm	BN083	16
84	Flat Universal Paint Brush 40mm	BN084	16
85	Flat Universal Paint Brush 50mm	BN085	16
86	Flat Universal Paint Brush 60mm	BN086	16
87	Flat Universal Paint Brush 70mm	BN087	16

CHIP BRUSH



ITEM	ARTICLE NAME	CODE	PCS PER PACKAGE [UNITS]
88	Paint Brush On Wood 30mm	BN088	16
89	Paint Brush On Wood 40mm	BN089	16
90	Paint Brush On Wood 50mm	BN090	16
91	Paint Brush On Wood 60mm	BN091	16
92	Paint Brush On Wood 70mm	BN092	16

FOAM GUN



ITEM	ARTICLE NAME	CODE	PCS PER PACKAGE [UNITS]
93	Foam Gun	BN093	1

BLOCK BRUSH, 'EXTRA'



ITEM	ARTICLE NAME	CODE	PCS PER PACKAGE [UNITS]
94	Block Brush 180mm	BN094	10

RENDER SCRAPER
WITH SPIKES

ITEM	ARTICLE NAME	CODE	PCS PER PACKAGE [UNITS]
95	Render scraper with spikes	BN095	

ANGLE TROWEL
- RASP FOR STYROFOAM

ITEM	ARTICLE NAME	CODE	PCS PER PACKAGE [UNITS]
96	Angle Rasp Trowel 270mm (for Styrofoam)	BN096	

PROFESSIONAL PAINTER'S
MASKING TAPE FOR CURVES

ITEM	ARTICLE NAME	CODE	PCS PER PACKAGE [UNITS]
97	Professional painter's masking tape for curves 36mm	TBN097	16

EXTERIOR MASKING TAPE FOR SMOOTH SURFACES



ITEM	ARTICLE NAME	CODE	PCS PER PACKAGE [UNITS]
98	Exterior masking tape for smooth surfaces 38mmx50m	TBN098	32
99	Exterior masking tape for smooth surfaces 48mmx50m	TBN099	24

STRONG DT PR SLIGHT ROUGH AND SMOOTH SURFACES



ITEM	ARTICLE NAME	CODE	PCS PER PACKAGE [UNITS]
100	Exterior masking tape for rough surfaces 48mmx50m	TBN100	24
101	Exterior masking tape for rough surfaces 38mmx50m	TBN101	32

ALUMINIUM TAPE



ITEM	ARTICLE NAME	CODE	PCS PER PACKAGE [UNITS]
102	Aluminium tape at-22 48mm x 25yd	TBN102	30

DOUBLE-SIDED



ITEM	ARTICLE NAME	CODE	PCS PER PACKAGE [UNITS]
103	Double-sided dpp-pr (h) 48mm x 25m	TBN103	24
104	Double-sided dscl-st (h) 50mm x 25m	TBN104	24

MASKING TAPE



ITEM	ARTICLE NAME	CODE	PCS PER PACKAGE [UNITS]
105	Masking tape [3 days] 48mmx50m	TBN105	24
106	Masking tape [3 days] 48mmx50m	TBN106	24
107	Masking tape [3 days] 48mmx50m	TBN107	28

PACKAGING SEALING TAPE



ITEM	ARTICLE NAME	CODE	PCS PER PACKAGE [UNITS]
108	Packaging sealing tape pt (tr) 48mm x 40yd	TBN108	36
109	Packaging sealing tape pt (br) 48mm x 40yd	TBN109	36

SELF-ADHESIVE PROTECTION FOIL



ITEM	ARTICLE NAME	CODE	PCS PER PACKAGE [UNITS]
110	Self-adhesive protection foil 600x15m	TBN110	9

CLS BEAD

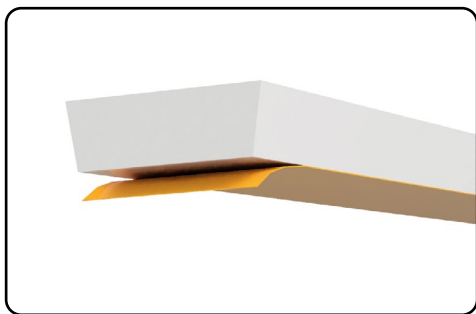

TECHNICAL DATA

MATERIAL BASE
ADHESIVE LAYER
APPARENT DENSITY
DIMENSIONAL STABILITY
RESISTANCE TO DEFORMATION
THERMAL RESISTANCE
WATER ABSORPTION
LENGTH

LISTWY CLS

PWC
ACRYLIC, RUBBER ADHESIVES, SILICONE PAPER
0.47-0.55g/cm³
STABLE
ALL RIGHT
FROM -40°C TO +60°C
LACK
1000 mm

CHARACTERISTICS:

- elastic
- adapts to the ground
- good adhesion to smooth and porous substrates
- does not leave traces of glue
- non-absorbent
- easy to use
- self-adhesive

ITEM	ARTICLE NAME	CODE	PCS PER PACKAGE [UNITS]
111	CLS BEAD	TBN111	1

Z Y	5	6	7	8	9	10	12
1	X	X	X	X	X	X	X
2	X	X	X	X	X	X	X
3	X	X	X	X	X	X	X
4	-	X	X	X	X	X	X
5	-	-	X	X	X	X	X

Type series in mm:



Size tolerance: Length +/- 2% Width +/- 0.5mm Thickness +/- 0.2mm

BRICK EFFECT STENCIL



MOULD WITHOUT WOOD KNOTS B1

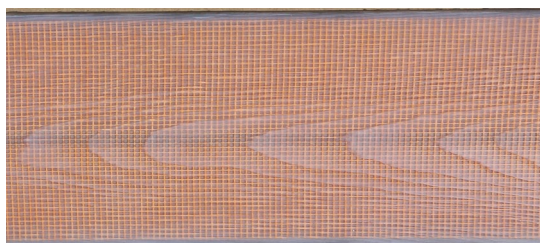

Size: Length: 200cm / Width: 20cm

ITEM	ARTICLE NAME	CODE	PCS PER PACKAGE [UNITS]
112	Brick effect stencil	TBN112	50

ITEM	ARTICLE NAME	CODE	PCS PER PACKAGE [UNITS]
113	Mould without wood knots B1	TBN113	1

MOULD WITH WOOD KNOTS B2

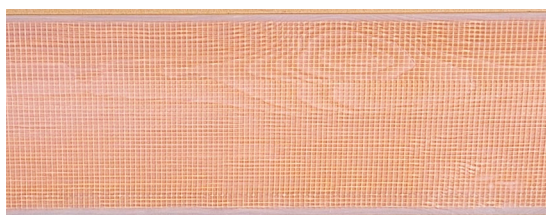

Size: Length: 200cm / Width: 20cm

SILICONE STENCIL B6 Concrete

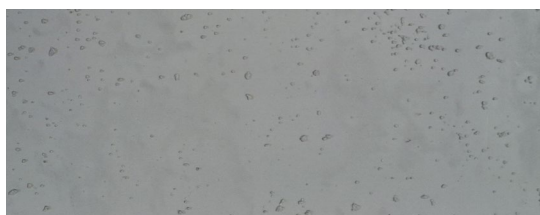

Size: Length: 80cm / Width: 40cm

ITEM	ARTICLE NAME	CODE	PCS PER PACKAGE [UNITS]
114	Mould with wood knots B2	TBN114	1

ITEM	ARTICLE NAME	CODE	PCS PER PACKAGE [UNITS]
115	SILICONE STENCIL B6 Concrete	TBN115	1

LBL GROOVE TROWEL - LBP-V1



TECHNICAL DATA

MESH SIZE [MM]
MESH SIZE [MM]
WIDTH [cm]
PACKAGE [m²]
COLOUR

LBP-V1

3.0x1.7
160
24
20
WHITE

CHARACTERISTICS:

Fabric bossage corners for creation and reinforcement of bossage in and at wall corners in the thermal insulation system - ETICS

ITEM	ARTICLE NAME	CODE	PCS PER PACKAGE [UNITS]
116	LBL-V GROOVE TROWEL	TBN116	1

CODE	PACKAGE [UNITS]
LBL-V GROOVE TROWEL	1

LBLN-V SPARE PART - LBP-V2

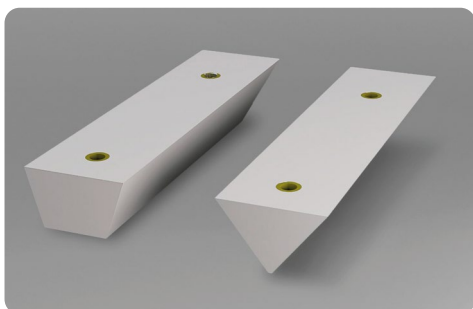

TECHNICAL DATA

MESH SIZE [MM]
MESH SIZE [MM]
WIDTH [cm]
PACKAGE [m²]
COLOUR

LBP-V2

PWC
3.0x1.7
160
24
20
WHITE

CHARACTERISTICS:

Fabric bossage corners for creation and reinforcement of bossage in and at wall corners in the thermal insulation system - ETICS

ITEM	ARTICLE NAME	CODE	PCS PER PACKAGE [UNITS]
117	LBLN-V SPARE PART	TBN116	1

CODE	PACKAGE [UNITS]
LBLN-V SPARE PART	1

LBP-HKV SPARE V-SHAPED BLADE - LBP-V3

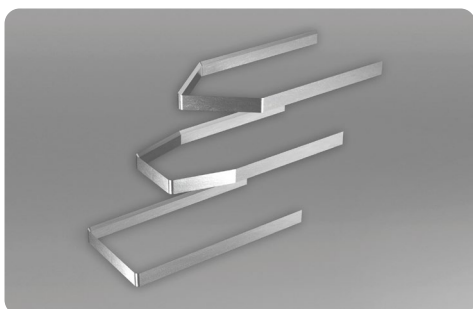

TECHNICAL DATA

MESH SIZE [MM]
MESH SIZE [MM]
WIDTH [cm]
PACKAGE [m²]
COLOUR

LBP-V3

3.0x1.7
160
24
20
WHITE

CHARACTERISTICS:

Cross mesh groove profile for reinforcement of bossage groove intersection in the thermal insulation system - ETICS

ITEM	ARTICLE NAME	CODE	PCS PER PACKAGE [UNITS]
118	LBP-HKV SPARE V-SHAPED BLADE	TBN116	1

CODE	PACKAGE [UNITS]
LBP-HKV SPARE V-SHAPED BLADE	1



OTHERS



SOLTHERM ZP*

FOAM FOR POLYSTYRENE BOARD INSTALLATION

- Excellent adhesion to polystyrene and mineral substrates
- Yield of 10m² if EPS boards are installed to walls
- Low-pressure
- Application temperature from -5°C
- Dowelling already after 2h
- Very good adhesion to bituminous substrates
- Very good thermal insulation
- Easy to apply

CODE	CONTAINER [M]	NO. OF CONTAINERS PER BOX [UNITS]	COVERAGE [DM ³]
TPI ZP	750	12	up to 0,55 (depends on ambient humidity and temp.)



SOLTHERM PM-L*

LOW-PRESSURE INSTALLATION FOAM

- Low-pressure, water resistant
- High yield up to 50dm³
- Very good thermal and sound insulation properties
- Application temperature range from -10°C to +30°C
- Resistant to fungi and mould
- Dimensionally stable

CODE	CONTAINER [M]	NO. OF CONTAINERS PER BOX [UNITS]	COVERAGE [DM ³]
TPI PML	680	12	up to 50 (depends on ambient humidity and temp.)



SEALING TAPE HYDRO-T*

- Made of polyester mesh and tight elastomeric sealing coating
- For embedding in sealing products like waterproofing membrane or sealants
- For waterproof bridging of expansion and edge joints and room corners
- 120mm wide

CODE	CONTAINER [M]	UNITS PER BOX [UNITS]
BOLIX HYDRO-T 10	10	1
BOLIX HYDRO-T 50	50	1



OUTSIDE SEALING CORNER

- Made of polyester mesh and tight elastomeric sealing coating
- Pre-moulded and pre-cut corners increase sealing tape tightness at corner seams
- Enhanced sealing properties and easy application

CODE	CONTAINER [MM]	UNITS PER BOX [UNITS]
BOLIX HYDRO-T 10	130x130	25



INSIDE SEALING CORNER

- Made of polyester mesh and tight elastomeric sealing coating
- Pre-moulded and pre-cut corners increase sealing tape tightness at corner seams
- Enhanced sealing properties and easy application

CODE	CONTAINER [MM]	UNITS PER BOX [UNITS]
Inside sealing corner	130x130	25

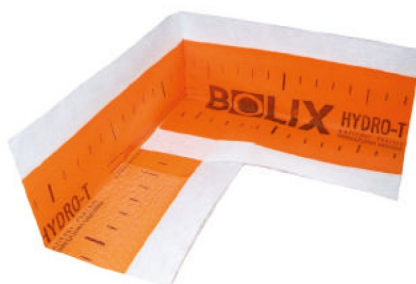

* Available in a universal container with a thermal printed label or under the brand name BOLIX. Both represent the same product.

SEALING TAPE HYDRO-TW*

- Made of polyester mesh and tight elastomeric sealing coating
- For embedding in sealing products like waterproofing membrane or sealants
- For waterproof bridging of expansion and edge joints and room corners
- 120mm wide

CODE	CONTAINER [M]	UNITS PER BOX [UNITS]
BOLIX HYDRO-TW 10	10	1
BOLIX HYDRO-TW 50	50	1



OUTSIDE SEALING CORNER

- Made of polyester mesh and tight elastomeric sealing coating
- Pre-moulded and pre-cut corners increase sealing tape tightness at corner seams
- Enhanced sealing properties and easy application

CODE	CONTAINER [MM]	UNITS PER BOX [UNITS]
BOLIX HYDRO-T 10	130x130	25



INSIDE SEALING CORNER

- Made of polyester mesh and tight elastomeric sealing coating
- Pre-moulded and pre-cut corners increase sealing tape tightness at corner seams
- Enhanced sealing properties and easy application

CODE	CONTAINER [MM]	UNITS PER BOX [UNITS]
Inside sealing corner	130x130	25

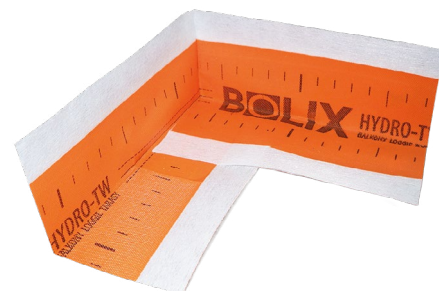

* Available in a universal container with a thermal printed label or under the brand name BOLIX. Both represent the same product.

**SOLTHERM
TRAINING NOTEPAD A5**
MGBI-SL-A5

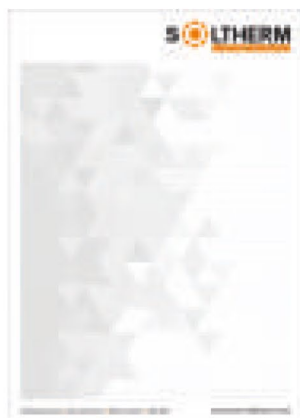

**SOLTHERM TRAINING
NOTEPAD A4**
MGBI-SL-A4

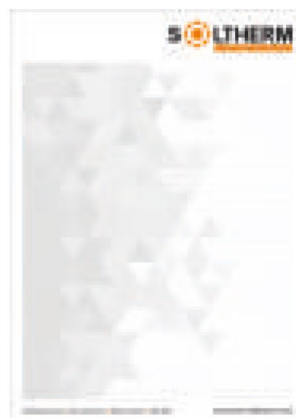

SOLTHERM ADHESIVE TAPE
MDPO-SL-NW

S  **L THERM**

S  **L THERM**



www.soltherm.eu

